

# LEEDERVILLE PRIMARY SCHOOL



PLACE INFORMATION	
<b>Place name</b>	Leederville Primary School (fmr)
<b>Other names</b>	Schools of Isolated & Distance Education
<b>Place type</b>	Individual building or group

HERITAGE LISTING	
<b>inHerit ID:</b>	3375
<b>State Heritage Register:</b>	
<b>Other Listing:</b>	Municipal Inventory Adopted 13 Nov 1995

SITE LOCATION	
<b>Street address</b>	164 Oxford St
<b>Locality</b>	Leederville
<b>Survey</b>	LOT: 3000 D/P: 45109
<b>Vol/folio</b>	LR3135/836
<b>Reserve</b>	RES: 2618

SIGNIFICANCE	
<b>Level of significance</b>	<b>Considerable</b> Very important to the heritage of the locality. High degree of integrity/authenticity.
<b>Management category</b>	<b>Category 2</b> Conservation of the place is highly desirable. Any alterations or extensions should reinforce the significance of the place.
<b>Statement of significance</b>	<p>The place has aesthetic value for its remaining form and detail of school buildings constructed in the Federation Arts and Crafts style.</p> <p>The former school and the adjacent recent buildings are landmarks in the streetscape</p> <p>The place has historic value for its association with the development of Leederville in the late 19th century and the need to provide education to the growing community.</p> <p>The place has historic value for its association with the development and change of educational services and facilities throughout the 20th century.</p> <p>This place is valued by the community for the continuity of its presence in the streetscape which contributes to the community sense of place.</p> <p>The place has social value for the many members of the community who attended the school or had family members who did so throughout the 20th century.</p>

PLACE USE	
<b>Original use</b>	Educational: Primary School
<b>Current use</b>	Educational: Administration Building
<b>Other use</b>	
CONSTRUCTION DETAILS	
<b>Construction date</b>	1895; 1990s
<b>Walls</b>	Brick
<b>Roof</b>	Corrugated metal sheeting
<b>Architectural Style</b>	Federation Arts and Crafts
<b>Physical description</b>	<p>The original buildings were constructed to a standard pattern for Government schools of the time, the one storey buildings have large hipped roofs, the relatively plain facades are well proportioned and embellished with bands of stucco, while the casement windows are multi paned. The roofs have tall corbelled chimneys.</p> <p>Additions were made a decade ago when the place was converted for Schools of Isolated and Distance Education. These later additions obscure the original buildings from the street.</p>
<b>Condition</b>	Good
<b>Integrity</b>	Moderate
<b>Authenticity</b>	Moderate

## HISTORICAL INFORMATION

Residents of the Leeder Estate, comprising a total of 99 children between them, petitioned the government for the establishment of a school in the area in June 1894. Five acres (Reserve No. 2618) was set aside for a school in Oxford Street (corner of Vincent) but part of it was later relinquished in favour of higher ground (the corner portion was low lying - the Leederville Post Office was built on this site in 1897) and plans were drawn for the new school. In the meantime the first classes for Leederville Primary School were held on 20 August 1894, in the Sunday School room of St Andrew's Presbyterian Church, on the corner of Oxford and Melrose streets. This was a timber building, 30 feet by 20 feet in size. It housed 39 children and was run by head teacher J. C. S. Deans with the aid of an assistant 15 year old Florence Wallace. Mrs Laura Deans, the head teacher's wife, actually taught this monitor how to teach sewing and fancy work to the children but she was not compensated for her efforts.

When the enrolments reached 100 in 1895, Deans was allocated a second monitor. The Leederville Primary School and head teacher's residence were constructed in 1895 by W. Fairweather, on part of the large reserve (then named B2618) on Oxford Street which already housed the Post Office, Municipal Offices, Town Clerk's residence and Police Station. There were 61 pupils enrolled in 1895, but only 49 of these were recorded as attending. The building appeared on the 1897 PWD sewerage plans but was not listed in Wise's Post Office Directories. By 1900 there were five staff members and Arthur Hill was the head teacher. The popularity of the school was such that further accommodation was required.

In 1902 an iron building was cut in half at Subiaco State School and half of it was erected at Leederville. Two new classrooms were also added this year by builder W.C Rose. Electric light was installed in 1905. Arthur Hill was headmaster from at least 1898 to 1904 and in 1903 he was also listed as the District Registrar. In 1904 the new headmaster's name (or head teacher) was H. K. Thomsett and he was also listed as the District Registrar. In 1907 the District Registrar was a separate posting to the headmaster and the incumbent was Patrick Stuart, JP. The Infants' School was opened on the Vincent Street frontage, east of the Post Office, on 15 September 1902. It was erected by Messers Franklin & Finlay.

## HISTORICAL INFORMATION

This school amalgamated with the Primary School on 1 July 1909. At that time John English was in charge and also listed were Miss Ella Butler in charge of Household Management (commenced in 1906) and Henry Scott as the Manual Training Instructor. Classes in these two subjects were also given to students from the Newcastle and Thomas Street schools and West Leederville. In 1915 and 1917 pavilion rooms were added and a brick classroom, cloakroom and teachers' room was constructed by W. N. Pearman in 1922. However, there was still not enough room and one class used a room at the rear of the Leederville Council Chambers. In 1925 a room was added to the Infants' School by F.L Gurr and in 1927 the school was substantially renovated by A. Woolhouse.

Len Brennan, a pupil from 1913, recalled supplying manure for the school's gardens from the stables in Carr Street where the 25 horses used to pull the wagons for this grandfathers' form, Golden West Aerated Water Company, were kept. Past pupil Jean Paizes also recalled 'that the girls were separated from the boys in class but, if we were naughty, we'd be sat next to them' (Guardian Express, 21.12.1993, p.3). The Primary and Infant schools were separated by a patch of black sand with a cricket pitch in the middle and 'one became a hero if he could hit a six into Leederville Oval' (Donald Cooley). There were also many reports of students with black feet and black marks on their clothes. Nevertheless, this was not the only venue used for cricket. Later on Ray Wemm's father Cliff was the cleaner at the school and Ray recalled playing cricket in the long corridor with his brother and sister in between helping his father during the school holidays.

According to the Wise's Post Office Directories, John (Paddy) English was the headmaster in 1925 and T. Harper in 1935 but unfortunately in 1949, the last year of the Directories, the head teacher was not listed. Further additions were carried out to the school in 1925 when a new classroom was added on the side hall and at the rear of an existing one. At this time the PWD's principal architect who signed the plans was W. M. Hardwick. In 1962 a small portion of land (one chain) was excised from the school grounds and added to Leederville Oval. This was done because the oval's grandstand was so close to the boundary.

Leederville Primary School closed at the end of 1993 just short of its centenary. The school's parent body put up a strenuous fight to keep it open with nearly 200 people attending one particular meeting, but the Education Ministry would not be moved. It was one of four schools closed that year as part of a rationalisation program. The last headmaster of the school was Matt O.Meara.

## HISTORICAL INFORMATION

After the school's closure extensive additions were made to the site for conversion of use to offices for the Education Department section, Schools of Isolated and Distance Education (SIDE). A covered outdoor area and barbecue were added in 2002. In May 2006 this school received special funding from the Federal government to boost 'Innovative in Science, Technology and Mathematics.'

Aerial photographs from the mid 20th century onwards show the gradual increase in structures at the subject site. In the late 1960s there were less than a dozen buildings surrounding the large green space. In the 1980s more structures were being added and by the beginning of the 21st century the school had nearly doubled in size. As mentioned above a covered area was added in the early 2000s and more structures were built lining the (now much smaller) green space in 2008. These additions were then removed, along with the remaining grass area in 2010 and two large buildings were constructed in their place. This was the most recent change to the subject site.

## HISTORICAL INFORMATION

Historic theme	Social Services: Education Peopling WA: Demographic Development	
Associations	J. C. S. Deans Florence Wallace W. Fairweather Arthur Hill W. C. Rose H. K. Thomsett  Messers Franklin & Finlay W. N. Pearman F. L. Gurr A. Woolhouse W. M. Hardwick Matt O. Meara	Head teacher Assistant Builder Head teacher Builder Head teacher and district registrar Builders Builder Builder Builder Architect Last head teacher
Sources	Municipal Heritage Inventory 2006. Landgate Aerial photographs 1953-2024.	

ADDITIONAL PHOTOGRAPHS



ARCHIVAL IMAGES

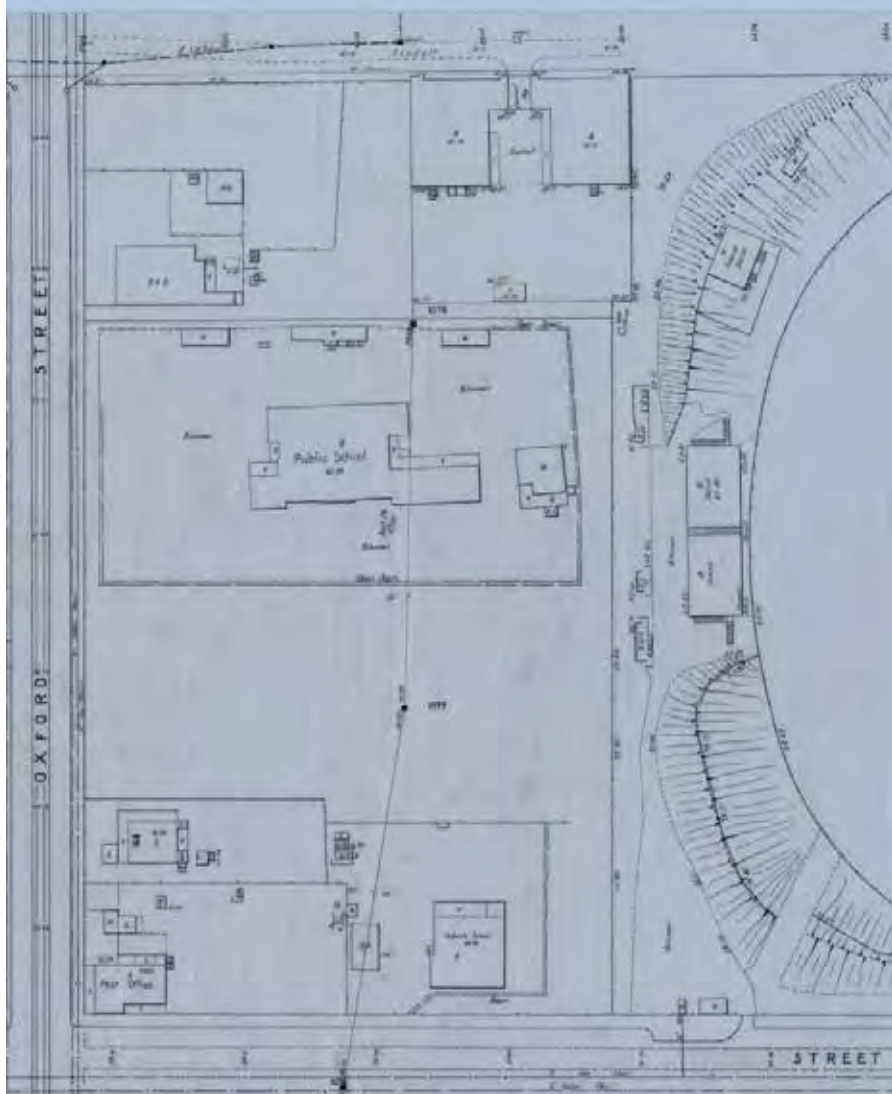

Sewerage Plan 1952. Courtesy SROWA series 634 cons 4156 item 0142.