

ST FRANCIS XAVIER CHURCH CATHOLIC SCHOOL, PERTH



PLACE INFORMATION	
Place name	St Francis Xavier Church Catholic School
Other names	
Place type	Individual building or group

HERITAGE LISTING	
inHerit ID:	18069, 8770
State Heritage Register:	
Other Listing:	Municipal Inventory Adopted 13 Nov 1995

SITE LOCATION	
Street address	19 West Pde
Locality	Perth
Survey	LOT: 1 D/P: 583 LOT: 2 D/P: 583 LOT: 3 D/P: 583
Vol/folio	1046/693 1046/693 1046/693
Reserve	—

SIGNIFICANCE	
Level of significance	Considerable Very important to the heritage of the locality. High degree of integrity/authenticity.
Management category	Category 2 Conservation of the place is highly desirable. Any alterations or extensions should reinforce the significance of the place.
Statement of significance	<p>The original church building constructed c1935 is a good and intact example of the Inter War Art Deco style executed in rendered brick and tile.</p> <p>The place has historic value for its association with the growth of this portion of East Perth in the Inter War years and particularly the influx of Catholic migrants to the state who settled in the vicinity.</p> <p>The place has historic value for the provision of education to the Catholic children in the district.</p> <p>The place has social value for the members of the community and their families who attended this school in the mid 20th century. Its presence in the streetscape contributes to the community sense of place.</p>

PLACE USE	
Original use	Education: Primary School
Current use	Health: Other
Other use	

CONSTRUCTION DETAILS	
Construction date	c1935
Walls	Brick and Brick Render
Roof	Terracotta Tile
Architectural Style	Inter-War Art Deco
Physical description	<p>The single storey school building is laid out in a form comparable with other neighbourhood Catholic primary schools of the period.</p> <p>It has a hipped tiled roof with walls of brick dado and render and double hung windows. The street façade has a central symmetrical feature formed by an Art Deco style stepped rendered parapet wall, with two sets of two double hung windows overlain with diagonal tracery. This Art Deco motif was used to articulate other key elements of the school.</p>
Condition	Good
Integrity	High
Authenticity	High

HISTORICAL INFORMATION

The Westralia Estate, on which the Church and school are located, was developed in 1895 on the western side of the Fremantle-Guildford Railway line, in the East Perth area, while the East Norwood Estate was developed in 1898, on the eastern side of the line.

St Francis Xavier School was constructed c1935, and the church was built the following year. The architect and builder of the school have not been determined.

The School served the comparatively poorly serviced neighbourhood east of Lord Street. It extends the already strong Catholic educational presence within the district such as Aranmore College and Sacred Heart College. The school is comparable, albeit modest in accommodation standards, with Catholic neighbourhood primary schools developed in other parts of the region in the Interwar period, such as Nedlands and Claremont.

In 1947, an application was submitted to the City of Perth to erect a school play shed at the subject site by St Mary's Cathedral, the then owner of the school. The plans show that the subject lot accommodates a church and a school and the subject place had an address of No. 25 Windsor Street, East Perth.

A Sewerage Plan dated 1953 illustrates that the School was built in a rectangular form, addressing Windsor Street. There was a verandah at the rear of the building. An asbestos outbuilding and two brick water closets were located at the rear of the subject lot.

In 1982, the Roman Catholic Archbishop of Perth submitted an application proposed to construct an extension at the rear of the existing Emmanuel Disabled Centre, which is addressing Windsor Street. The building continues to be part of the Catholic Church stock and services.

HISTORICAL INFORMATION

Historic theme	Social Services: Education Cultural Life: Religion
Associations	
Sources	Municipal Heritage Inventory 2006 Landgate Aerial photographs 1953-2024.

ADDITIONAL PHOTOGRAPHS

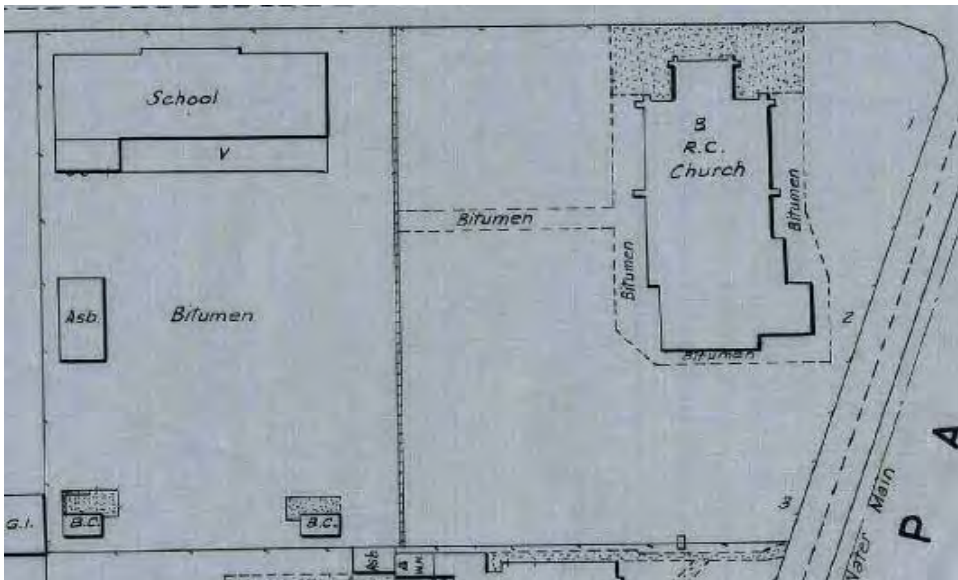

Sewerage Plan 1952. MWSSDD Sheet 88, Courtesy SROWA.