

ST. FRANCIS XAVIER CHURCH, PERTH



| PLACE INFORMATION | |
|-------------------|------------------------------|
| Place name | St Francis Xavier Church |
| Other names | |
| Place type | Individual building or group |

| HERITAGE LISTING | |
|--------------------------|---|
| inHerit ID: | 8770, 18069 |
| State Heritage Register: | |
| Other Listing: | Catholic Church Inventory Adopted 01 Jul 1998 |

| SITE LOCATION | |
|----------------|---|
| Street address | 19 West Pde |
| Locality | Perth |
| Survey | LOT: 1 D/P: 583 LOT: 2 D/P: 583 LOT: 3 D/P: 583 |
| Vol/folio | 1046/693 1046/693 1046/693 |
| Reserve | — |

| SIGNIFICANCE | |
|---------------------------|--|
| Level of significance | Considerable Very important to the heritage of the locality. High degree of integrity/authenticity. |
| Management category | Category 2 Conservation of the place is highly desirable. Any alterations or extensions should reinforce the significance of the place. |
| Statement of significance | <p>The place has aesthetic value as a good and intact example of the inter War Gothic style executed in brick and tile with remaining detail evident on the external elevations.</p> <p>The place is a landmark in the streetscape as a large and prominent building in a leafy green setting in contrast to the industrial aesthetic of the adjacent railway line.</p> <p>The place has historic value for its association with the growth of this portion of East Perth in the Inter War years and particularly the influx of Catholic migrants to the state who settled in the vicinity.</p> <p>The place contributes to the community's sense of place for its role in the provision of social spiritual services to the community since 1936.</p> |

| PLACE USE | |
|---------------------|--|
| Original use | Religious: Church, Cathedral or Chapel |
| Current use | Religious: Church, Cathedral or Chapel |
| Other use | |

| CONSTRUCTION DETAILS | |
|-----------------------------|--|
| Construction date | 1936 |
| Walls | Brick |
| Roof | Terracotta tile |
| Architectural Style | Inter-War Gothic |
| Physical description | A facing brick, Inter-War Gothic church with a large, tiled gable forming the nave. All gable roof ends are topped with a decorative cross symbol at the apex and the gabled walls have concrete coping. Addressing Windsor Street, protruding from the open gable at ground level, is a small, flat roof vestibule with entry doors on either side. The vestibule is adorned with concrete detailing on the parapet wall and a low pitch gable parapet on the principal façade. Under this gabled parapet are three windows with buttresses on each corner. Above the vestibule is a set of three-pointed arch windows. Around the church building are buttresses and on each longitudinal side of the naïve are four-pointed arch windows. At the rear of the church the roof steps down to a lower gable, forming the chancel with two transepts protruding from each side. On the face of the rear open gabled end is another set of three-pointed arch windows. Concrete mouldings run around the perimeter of the church varying the look of the facing brick. The church has a generous curtilage landscaped with paths, seating and well-kept gardens. Vestibule has a small setback from Windsor Street |
| Condition | Good |
| Integrity | High |
| Authenticity | High |

HISTORICAL INFORMATION

The gold discoveries of the 1890s changed the face of the Catholic Church by bringing an influx of lay Catholics from the eastern states of Australia whilst big waves of migration between 1920s and post-World War II meant the rapid expansion of parishes and schools in Perth and the country areas.

The Westralia Estate, on which the Church and the adjacent school are located, was developed in 1895 on the western side of the Fremantle-Guildford Railway line, in the East Perth area, while the East Norwood Estate was developed in 1898, on the eastern side of the line.

St Francis Xavier School was constructed c1935, and the church was built the following year.

St Xavier's Catholic Church was constructed in the Inter War Gothic style in 1936 to a design by architects Cavanagh and Cavanagh and built by Mr A. Hill for £1834 and furnished for £200. The church was opened and blessed by Archbishop Dr Prendiville on 6 December 1936. The church was described on completion as follows.

It is a small but complete church containing nave, sanctuary, sacristy, choir gallery, confessionals and entrance porch. It is constructed of brick and concrete, with steel frame windows, jarrah frame ceiling and floor, and a roof of Marseilles tiles.

The church has had minimal change since its construction apart from some minor additions to the rear of the church.

HISTORICAL INFORMATION

| | | |
|-----------------------|---|-------------------------------------|
| Historic theme | Cultural Life: Religion Peopling WA: Demographic Development | |
| Associations | Cavanagh and Cavanagh Mr A. Hill | Cavanagh and Cavanagh Mr A. Hill |
| Sources | Municipal Heritage Inventory 2006 Landgate Aerial photographs 1953-2024. The West Australian, 5 December 1936, p. 4 | |

ADDITIONAL PHOTOGRAPHS



ADDITIONAL PHOTOGRAPHS

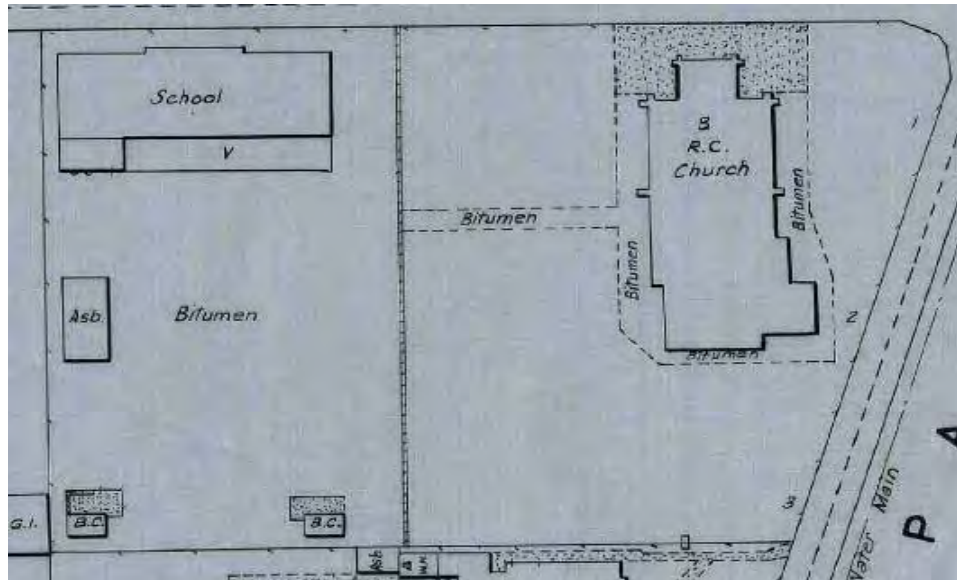

Sewerage Plan 1952. MWSSDD Sheet 88, Courtesy SROWA.



St. Francis Xavier's Roman Catholic Church at the corner of Windsor-street and Railway-parade, East Perth, which will be opened tomorrow afternoon by Archbishop Prindiville. The architects were Messrs. Cavanagh and Cavanagh.

The West Australian, 5 December 1936, p. 4.