

NORTH PERTH CHAPEL, NORTH PERTH



PLACE INFORMATION	
Place name	North Perth Chapel
Other names	North Perth Brethren Hall The Chapel Space Studio
Place type	Individual building or group

HERITAGE LISTING	
inHerit ID:	27559
State Heritage Register:	
Other Listing:	

SITE LOCATION	
Street address	117 Angove St
Locality	North Perth
Survey	LOT: 503 D/P: 41138
Vol/folio	2053/4 2583/568
Reserve	—

SIGNIFICANCE	
Level of significance	<p>Moderate</p> <p>Contributes to the heritage of the locality. Has some altered or modified elements, not necessarily detracting from the overall significance of the item.</p>
Management category	<p>Category 3</p> <p>Conservation of the place is desirable.</p> <p>Any alterations or extensions should reinforce the significance of the place and retain original fabric where feasible.</p>
Statement of significance	<p>The former church has aesthetic value as it demonstrates a simple, intact and late example of the Inter War Romanesque style executed in brick and tile.</p> <p>The place is a landmark on this prominent corner on this main arterial road.</p> <p>The place has historic value for its demonstration of the growth of this area of North Perth in the period following World War Two.</p> <p>The place has historic value for its association with the Brethren Christian community who have made a contribution to the Western Australian community since the 19th century.</p> <p>The place has social value for its ongoing presence in the streetscape and therefore contributes to the community sense of place.</p> <p>The place has been the venue of social and spiritual events since c1956 which have been attended by wide sections of the community.</p> <p>The recent use of the place as a private residence demonstrates a change in approach to the reuse of religious buildings.</p>

PLACE USE	
Original use	Religious: Church, Cathedral or Chapel
Current use	Residential: Single Storey Residence
Other use	Social/Recreational: Community Hall

CONSTRUCTION DETAILS	
Construction date	c1956
Walls	Brick
Roof	Terracotta Tile
Architectural Style	Inter War Romanesque
Physical description	<p>This single storey brick and tile building with a simple gable roofs, has an 'L' shaped plan form with the rectangular brick hall slightly proud of the entry wing to the west.</p> <p>The main façade of the hall features 3 slender timber sash windows, divided by two fluted cement rendered elements. A stepped brick detail is located on the corners, at the junction with the roof and wall. Contrasting bricks have been used in the angled sills.</p> <p>The long facades of the hall are divided by evenly spaced brick buttresses and timber sash windows. The entrance to the hall is via the adjoining wing where the entry door is framed by contrasting brick borders.</p> <p>The building is located on a sloping site and a terrace has been constructed across the front of the building and it is separated from the street level by a limestone retaining wall. Slender metal railings form a balustrade on top of the retaining wall.</p> <p>The western side of the building is raised by limestone foundations, and stone steps are located on this side of the terrace.</p>

CONSTRUCTION DETAILS	
Condition	Good
Integrity	High
Authenticity	High

HISTORICAL INFORMATION

This portion of North Perth was subdivided for residential settlement in 1896 however it was not significantly developed until the Inter War period as the population settled to the north of Perth.

This site was undeveloped until transferred to the Brethren Christian Group and plans prepared for the construction of a church hall. These plans were prepared by D. J. Reid, a member of the Association of Building Technicians, and dated 8 October 1956. It is likely this was Donald James Reid, a building supervisor work in Perth at this time. The date of construction is not confirmed however aerial photographs indicate that the church hall was built by 1961.

Brethren assemblies have existed in Australia since the 1850s. Holding congregational autonomy as a core principle, they long resisted forming any kind of central organization, preferring to operate as a network bound together by relationships rather than organized bodies. A number of organizations aiming to support the Brethren movement did arise, however, and gained widespread acceptance among the assemblies. These included the Stewards Foundation (established 16 July 1965). A national committee was established in 2006, which was subsequently incorporated as the Christian Community Churches of Australia. Not all Brethren assemblies affiliated to it immediately; the Western Australian Brethren did not join it until 2013.

It is not known when the place ceased to function for religious purposes. In recent years, the hall has been used for hire as a dance and function space. It is now used as a private residence. No changes to the form or extent of the building can be seen in the aerial photographs of the place since 1961.

HISTORICAL INFORMATION	
Historic theme	Cultural Life: Religion Cultural Life: Domestic Life
Associations	Donald James Reid Building Designer
Sources	Christian Community Churches of Australia, Wikipedia. https://en.wikipedia.org/wiki/Christian_Community_Churches_of_Australia State Records Office of WA Archives, Public Health Plans. Cons 5094 item 1312, North Perth Church for Brethren - Angove Street - Plans

ADDITIONAL PHOTOGRAPHS



ARCHIVAL IMAGES

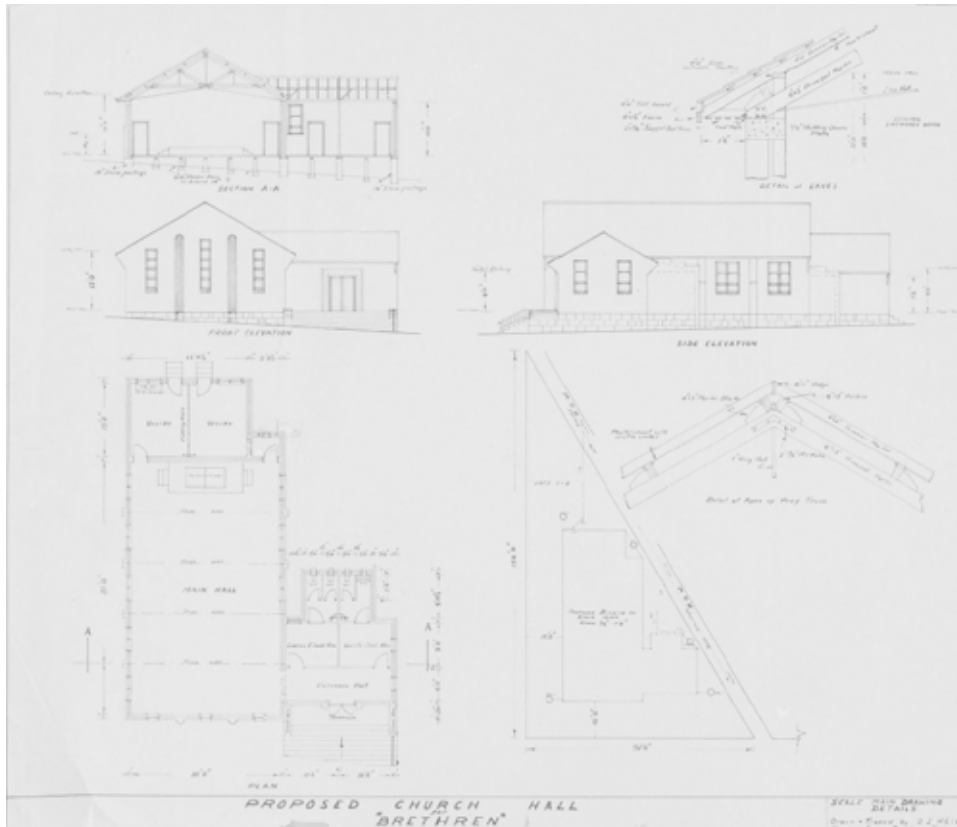

Proposed Church Hall for "Brethren", 5 Oct 1956. Courtesy SROWA Cons 5094 item 1312.