

5.8 MOUNT HAWTHORN YOUTH SKATE SPACE

- Attachments:**
1. **Mount Hawthorn Youth Skate Space - Preliminary Consultation Summary**
 2. **Mount Hawthorn Youth Skate Space - Concept Plan**
 3. **Mount Hawthorn Youth Skate Space - Concept Perspectives**
 4. **Mount Hawthorn Youth Skate Space - Consultation Summary**

RECOMMENDATION:

That Council **ENDORSES** the Mount Hawthorn Youth Skate Space Concept Plan at Attachment 2.

PURPOSE OF REPORT:

To seek Council's endorsement of the Mount Hawthorn Youth Skate Space Concept Plan (Concept Plan).

BACKGROUND:

In August 2020, John Carey MLA started a 'community conversation' on Facebook and conducted a community survey to obtain feedback on potential skate and scooter facilities in either Mount Hawthorn or North Perth. 207 respondents participated including 113 (54.59 percent) from Mount Hawthorn, 60 (28.99 percent) from North Perth, 18 (8.7 percent) from Leederville and the remaining 16 (7.72 percent) were from surrounding suburbs.

The survey findings indicated strong support for a youth skate space in or around the suburb of Mount Hawthorn. The findings indicated there was a gap of skate facilities in this area, while also acknowledging the proximity to the Leederville Skate Park. Survey respondents highlighted the potential for a Mount Hawthorn skate facility to complement the Leederville Skate Park through the provision of smaller facilities suited to entry level skaters.

During the State Election in 2021, an election commitment of \$200,000 was announced for a new skate/scooter park in Mount Hawthorn. Following the results of the State Election, the City submitted a funding application for the \$200,000, made as a part of the State Government Election Commitment to "Create a new skate facility for the children in Mount Hawthorn and surrounding suburbs." The City's application was successful, and the total \$200,000 election commitment funding amount has since been received.

In July 2021, the Mount Hawthorn Skate Working Group (Working Group) was established to collaborate and progress the planning of the Mount Hawthorn Youth Skate Space (skate space) project. The Working Group consists of Council Members, representatives from Administration and key stakeholders representing the Mount Hawthorn youth and the local skate community.

On 14 September 2021, the Working Group conducted a site analysis of Axford Park, Britannia Reserve and Charles Veyard Reserve. The site selection criteria for consideration included physical site conditions, access and transport, natural surveillance and security, proximity to amenities, impact on existing facilities and users, distance from housing and maintenance of the space.

The site analysis concluded that Britannia Reserve was the preferred site. The Working Group reviewed a number of different locations within Britannia Reserve and determined that the proposed site adjacent to the pump track would allow for the best design outcome and maximise user benefit to the local community, due to its sizeable area and ability to co-locate with amenities that cater towards a similar user demographic.

Preliminary community consultation on the skate space was conducted from 22 July to 3 August 2022, 140 survey responses were received during this period. A summary of submissions from the preliminary community consultation is included at **Attachment 1**. The report details comments received in relation to the location of the skate space, and initial design considerations that informed the Concept Plan.

The Concept Plan, included in **Attachment 2**, was designed in response to the preliminary engagement and to complement the existing amenities at Britannia Reserve. The skate space and elements have been designed to cater towards younger children and entry-level skaters, with all elements being under 1m high from the current surface level. With skate elements being of this smaller scale, it will also assist with

integrating the skate space into the existing landscape. Additional planting and turf banks will create this integration.

The Concept Plan includes 'earthy tone' coloured concrete to also complement the existing landscape, as well as being a cost effective colour choice. The Concept Plan Perspectives, included in **Attachment 3**, show a number of differing viewing perspectives.

The Concept Plan presents a skate space that would be approximately 350 square metres. This is deemed appropriate for young children to safely use and includes amenities such as shade structures and seating to allow parents and families to comfortably spend more time at the location.

The skate space has been designed to enable a suitable buffer zone through planting and greenspace to clearly separate the skate space and the reserve, adjoining active pathway, and sporting grounds to limit impacting current user activities such as sporting and dog walking. The use of logs will also provide additional seating and serve as buffers from the nature trail and pump track, to reduce unexpected drop-ins from BMX and mountain bike riders.

Active lighting of the skate space was considered by the Working Group however was not included in the Concept Plan due to its intent to accommodate younger children that would not be using the skate space after dark.

The Concept Plan has been designed to allow for effective drainage with consideration for ongoing maintenance. The City's Parks team have indicated that this space would be blown down twice weekly, opposed to other locations that would require daily sweeping due to the close proximity to overhanging trees.

On 18 October 2022 at its Ordinary Meeting, Council approved advertising of the Concept Plan for formal community consultation.

DETAILS:

The Concept Plan (**Attachment 2**) was advertised during the community consultation period between 19 October and 9 November 2022.

The community consultation included the opportunity for comment on the proposed layout and its integration into the current landscape. The survey sought feedback on the design of the skate space, suitability of the skateable elements for young children and entry level skaters, its interaction with current reserve activities and associated landscaping.

A high-level summary of survey responses includes:

- 96.7 percent of respondents live within Vincent, with the majority living within 500 metres (51.7 percent) and 1 kilometre (36.7 percent) of Britannia Reserve.
- 90 percent of respondents are supportive of the Concept Plan.
- 94.8 percent of respondents believe the skate elements included are suitable for younger children and entry-level skaters.
- 26.7 percent of respondents completed the preliminary project survey.
- 89.5 percent of respondents are supportive of the layout and design of the skate space.

The outcomes of community consultation including the survey results and email submissions are included as **Attachment 4**.

The Concept Plan was discussed with the Bridya Elders on 28 September 2022, to better understand the historical significance of Britannia Reserve and identify opportunities through stories and interpretive elements. It was noted by the Bridya Elders that laying concrete, takes away history and balance of the land, and the inclusion of plants and trees restores this balance. The Bridya Elders were supportive of the skate space and creating more opportunities for kids to play outside and interact.

The Concept Plan was presented to the City's Design Review Panel (DRP) on 16 November 2022, to discuss opportunities to improve the supporting infrastructure and landscape, to provide an amenity that is suitable for the current and future context of the site. The DRP members noted the location and importance of passive surveillance given its not close to a road, maximising logs and the grass embankment for informal natural seating, and opportunities for sustainable materials. The DRP members recommended consideration

towards environmentally sustainable design principles where possible during detailed design, such as recycled concrete in the construction and a natural biofiltration system for surface runoff. This will be considered through detailed design.

A summary of the community consultation results were presented to the Working Group. The Working Group considered all feedback and agreed that no amendments were required to the Concept Plan. The Working Group are supportive of the Concept Plan to guide implementation of the skate space.

No changes were made to the Concept Plan following positive feedback through the formal community consultation and consultation with the Bridya Elders, DRP and Working Group.

CONSULTATION/ADVERTISING:

Formal community consultation on the Concept Plan was undertaken to confirm that the design suitably reflects the community sentiment following the preliminary consultation period. This investigated:

- The skate space design and skateable elements;
- The supporting infrastructure to encourage extended usage; and
- The surrounding landscaping for site integration.

The consultation campaign included:

- [Imagine Vincent](#) project page containing the online survey.
- Social media campaign and news item on the City's website.
- Postcard drop to surrounding residents (1377 postcards).
- Signage in Britannia Reserve.
- Pop-up session at Britannia Reserve (5 November 2022).

A summary of the consultation engagement includes:

- Survey participants: 60 (54 online and 6 paper submissions).
- Email submissions: 2.
- Total page visits: 424.
- Social media interactions (1 post): 41 reactions & 9 comments.

LEGAL/POLICY:

Nil.

RISK MANAGEMENT IMPLICATIONS

Low: It is low risk for Council to endorse the Concept Plan for implementation.

STRATEGIC IMPLICATIONS:

This is in keeping with the City's *Strategic Community Plan 2018-2028*:

Enhanced Environment

Our parks and reserves are maintained, enhanced and well utilised.

Connected Community

We have enhanced opportunities for our community to build relationships and connections with each other and the City.

Our community facilities and spaces are well known and well used.

Thriving Places

Our physical assets are efficiently and effectively managed and maintained.

Innovative and Accountable

*Our resources and assets are planned and managed in an efficient and sustainable manner.
Our community is satisfied with the service we provide.
We are open and accountable to an engaged community.*

SUSTAINABILITY IMPLICATIONS:

This does not contribute to any environmental sustainability outcomes. This action/activity is environmentally neutral.

PUBLIC HEALTH IMPLICATIONS:

This is in keeping with the following priority health outcomes of the City's *Public Health Plan 2020-2025*:

Increased mental health and wellbeing

Increased physical activity

FINANCIAL/BUDGET IMPLICATIONS:

The Concept Plan has been designed to the construction budget of \$200,000, which is the amount of funding received by the State Government. The funding agreement term is due to expire 30 June 2023.

To develop the Concept Plan, \$30,000 was included in the City's 2022/23 annual budget.

COMMENTS:

The feedback received during the consultation period and through various reference groups was very positive.

The skate space will be another complementary asset to Britannia Reserve without impacting the various activities it currently provides to the local and surrounding community.

It is recommended that Council endorse the Concept Plan due to the initial community consultation that informed its design, and community feedback received during formal advertising in response to the Concept Plan.

Mount Hawthorn Youth Skate Space – Preliminary Consultation Summary

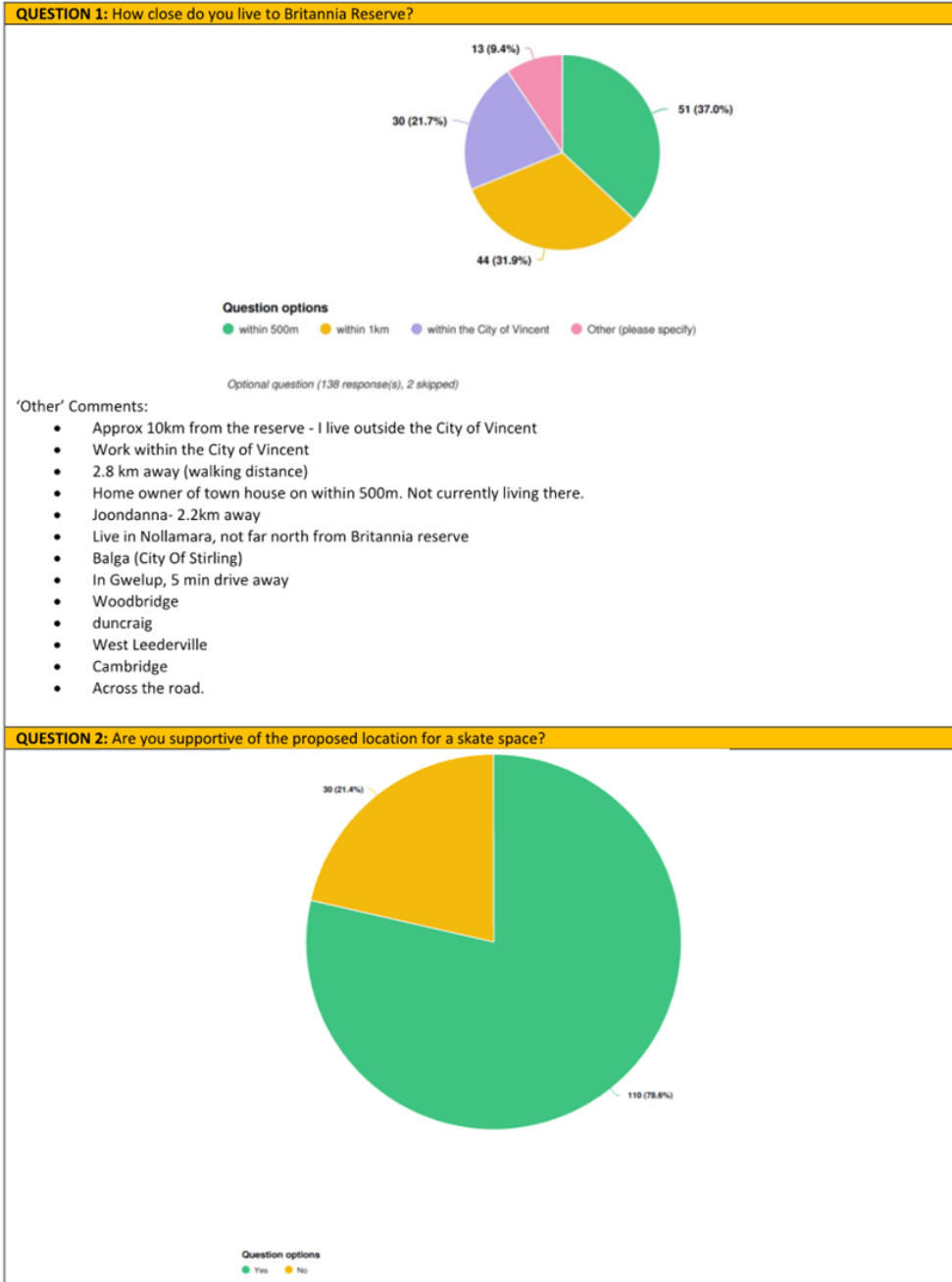

QUESTION 3: Do you have any comments on the proposed location of a skate space?	
Submitter Comments Verbatim	Administration Comments
Cambridge have just built a skate park on the eastern side of Lake Monger, so the proposed location at Britannia will mean two skate parks within spitting distance. It may be better to have the skate parks more spread out in the community	The Town of Cambridge recently opened their Lake Monger Pump Jump Track, however this is not the same facility. This proposed skate space will be designed towards younger children and entry-level skaters, and will enable them to develop their skills and eventually transition to the Leederville Skate Park and other more advanced skate parks.
think make more sense in north perth given closer skate park in Leederville already but also makes sense given the pump track	Noted.
Pleased it is a reasonable distance from residential areas to minimise noise disruption. Also pleased it is at a multi use park in terms of visiting not solely to use the skate facility but also the oval and playground.	Noted.
I would have put it further up from the proposed location, where the ramp down to car park is in front of the cricket oval	This area was considered, however would impact on the sporting grounds and be in the potential vicinity of cricket balls.
Ensure good lighting and security surveillance is in place, and it's included in city security drives	Design related submission noted for consideration.
Its a fantastic idea. Young people need places to go to be able to socialise, meet friends old and new, to be outdoors in the fresh air.	Noted.
Please note I am 100% for a skate park in Mount Hawthorn.	Noted.
Teenagers should be able to easily get to the skatepark by themselves. Locating it at Britannia means that it is not near any major thoroughfare or bus routes. Several roads on the north side of Britannia have not been resurfaced for a while and so are poor to ride on with skateboards and scooters that have hard wheels. There are also no local shops nearby where people can get drinks/snacks. In my opinion Axford would have been a much better location.	
Too hidden there, need to be closer to public space, Leederville skate park is only a 5 minute walk away, needs to be closer to the mezz and more visible	Noted.
It's a great location - I'm very excited to see this go ahead.	Noted.
What a fantastic location and addition to the Britannia Reserve precinct!	Noted.
I am largely in favour of a skatepark anywhere. However, there are already facilities in this space (pump track) and it is in relatively close proximity to the Leederville skatepark. I think somewhere closer to the heart of Mt Hawthorn would be preferable, such as Axford Park, Blackford St Park or Braithwaite.	The proposed location was preferred by the project Working Group to complement the existing amenities at the site. Also acknowledging the proximity to Leederville Skate Park, however will provide the opportunity for younger skaters with smaller scale skate elements compared to Leederville. Various parks around Mount Hawthorn and North Perth were identified, however Britannia Reserve was the preferable site to achieve the best design outcome and benefit to the community.
brilliant	Noted.
make sense to put it near the pump track. Will there be room to expand the skate park in the future?	There is no current scope to expand in future, however the proposed area would allow for the inclusion of future skate elements to be added.
Being near the pump track is great!	Noted.
Should be close to parking if possible	Site analysis was conducted with locations closer to the car park, however would impact the current sporting activities. The proposed site is still seen as within an appropriate distance to walk/ride/skate from the car park.
Britannia (and Mt Hawthorn in general) already have a lot of recent upgrades to facilities including the pump track and Braithwaite Park playground. North Perth has very little in terms of options for older children so I would prefer to see a skate/scooter park at Charles Veryard.	The funding was nominated to the Mount Hawthorn and North Perth areas respectively. Upon conducting site analysis, Charles Veryard needed further considerations to ensure a skate space would not impact the current sporting activities and dog exercise area, and was noted as a potential site in future.
This is too close to off lead dogs. Many dogs are reactive to skateboards and will chase and snap at the riders. Having the skate park in that location will also result in more skateboards on the bike paths around the park. This is dangerous and may result in serious accidents. If a skate park is located on Britannia oval many people will be unable to have their dogs on the park. I would be very sad if this proposal goes ahead.	The high frequency of dog walkers was acknowledged when considering the proposed location and accounting for the size of the reserve that these users could co-exist with an appropriate design. The skate space will be located as far as possible from the active path and sporting reserve, and will include natural buffering with trees, greenspace and logs.
It should not be near an aged care facility or in an area used by so many pedestrians and dog walkers	The high frequency of dog walkers and general users was acknowledged when considering the proposed location and accounting for the size of the reserve that these users could co-exist with an appropriate design. The skate space will be located as far as possible from the active path and sporting reserve, and will include natural buffering with trees, greenspace and logs.
As someone who works with youth through arts and education, I can confidently say that a very limited group of young people use skate parks. There is already one 2.5km at the YMCA. Instead of pulling out the stock standard, consult with the local youth about what they want or think is missing from the local area. If young people are involved in the creation, they are more likely to use the space and respect the space! Alternatively consider creating a nature playground for younger people.	The initial survey conducted by John Carey MLA and the local town team (Mount Hawthorn Hub) received close to 200 submissions supporting a skate and scooter facility in the area. The project Working Group contains varying representation of schools, youth and the skate community have also advised of the support for a skate space that will target younger children and families in the local area. The City have recently upgraded a number of nature playgrounds, and are always interested to hear from the community on what other facilities/amenities they would like to see in their local area.
It's a great idea for this space. Strongly support it.	Noted.
Restively close to the Leederville skate park but great to make use of the new lights. No residents close by so noise shouldn't be an issue. Close to me so I'm happy.	Noted.
Perfect location	Noted.
There are two skate parks within 2 km of Britannia Reserve. If the City must spend the grant on a skate park, it would be better built elsewhere. I would, however, prefer the funds were spent on something more inclusive to all age groups, or on improvements to existing facilities in the City Although it is a bit remote from other facilities, it is part of a hub for biking, skating etc.	The funding objective from the State Government grant is to construct a youth facility that will be catering towards families and young skaters that will be addressing a need outlined by the community. The skate space design will also include considerations to enable any ability skater to use the skate space.
Would love to see similar pump track/jump line (for all ages) that is at Lake Monger but understand budget limitations. The location would compliment the existing pump track and nature trail, offering more choices for everyone.	Noted.
This would be an amazing addition to the pump track which we already use regularly. Fantastic to see facilities yo keep youth engaged in positive activities	Noted.
The location is isolated in the park, however may offer some reduction in noise disturbances for local residents if they were to perceive that as an issue.	Noted.
"This isn't a Yes/No question. It's a "YES" if the facility provides sufficient barriers, physical or otherwise, to protect kids and dogs. It's a "NO" if it results in dogs and kids having unsafe interactions. I am the admin on a page for dog walkers at Britannia Reserve. Mostly we reconnect people with things they've lost, and encourage each other to pick up dog poop. I'm in favour of community facilities for families, and am conscious I am part of a growing cohort of people who - for whatever reason - couldn't have kids. This means my dog is a family member. In the past year there has been at least one dog was seriously injured when a kid on a bike ran over it. I am sure you saw the commentary around this.	The high frequency of dog walkers and general users was acknowledged when considering the proposed location and accounting for the size of the reserve that these users could co-exist with an appropriate design. The skate space will be located as far as possible from the active path and sporting reserve, and will include natural buffering with trees, greenspace and logs.

<p>A facility with fast-moving skateboards and scooters - which even the most well-behaved dog might be spooked by - does in my view pose a risk to the many dog walkers who use Britannia often twice a day.</p> <p>Providing some sort of strategy is in place, this seems like a cool thing. I am sure there are smarter planning people than me at this type of challenge but I'd reckon maybe things like:</p> <ul style="list-style-type: none"> - No food in or near the skate park - Surrounding the park with a barrier - the big logs seem like a decent solution - maybe some peak times to avoid for kids. Dog walkers are usually a 7am-9am and 5pm-6pm mob. - Age requirements to under 12s. - Adult supervision requirements - Clear rules to "not" skate down the footpath, but instead access via the pump track. 	<p>Design related submission noted for consideration.</p>
<p>I have been unable to walk safely around the path on the reserve since pump path put in. This is rarely used, but kids on bikes have ridden 'open slather' on the foot path. God only knows how it will be with a skate park here. Presently they whiz along the path at break neck speed, ignoring pedestrians. Seniors have been eradicated from the equation & no attempt has been made to include us.</p>	<p>The active footpath is not in the project scope, however note this comment for reserve considerations and if regular conflicts emerge following its implementation then will look at measures to alleviate this.</p>
<p>It's a good location, Les Lilliman reserve would be better</p>	<p>Noted.</p>
<p>I do not want a skate park to be placed at Britannia Park. It would ruin the peaceful enjoyment and natural elements of the park. Leederville already has a skate park on Oxford Street.</p>	<p>Noted.</p>
<p>As a dog owner, my only concern would be to ensure adequate separation between dogs & the skate park to keep both kids & pets safe. The worst case scenario would be a dog falling into a skate bowl or a child being attacked by a larger dog that is triggered to "chase" a child on a skateboard. The current scenario with the tree trunks provides a good barrier for the bike track.</p> <p>I'd also be sad if this meant that the current "mini" jumps track was removed (I've even seen little kids bringing their remote control cars to use which is a gorgeous use of the space!).</p> <p>It would be a better use of area if there was tables & chairs put there for people to have a coffee/brunch and a spot for food trucks to park - like the acai van that goes to Lake Monger or the food trucks in Mt Hawthorn/Floreat (could be a Bites at Britannia events over summer): especially on weekends for those families watching sports.</p>	<p>This high frequency of dog walkers and general users was acknowledged when considering the proposed location and accounting for the size of the reserve that these users could co-exist with an appropriate design. The skate space will be located as far as possible from the active path and sporting reserve, and will include natural buffering with trees, greenspace and logs. Shade structure and appropriate seating will also be considered with the design.</p>
<p>I think the idea of using this space for youth amenity is great but not sure if a skatepark is the right thing as there is one in Leederville and Lake monger has good new bmx pump track. Maybe a 'ninjab' obstacle course for teenagers/ young adults would be better?</p>	<p>The skate space has been funded by the State Government to address community feedback towards the shortage of skateable infrastructure that caters to younger children. The City have recently upgraded a number of nature playgrounds, and are always interested to hear from the community on what other facilities/amenities they would like to see in their local area.</p>
<p>I am not in favour of this proposal. There is already a skate park in Leederville. A skate park is not consistent with the existing nature of the area. Even though there is already a jump park the introduction of scooter, skateboards and more bikes conflicts with other activities in particular elderly people walking and odd exercising. Many dogs get spooked by scooters and skate board which could lead to injuries to both dogs and users of the proposed facilities. I do not wish to see further reduction in vegetation. On the contrary there ought to be greater vegetation.</p>	<p>This high frequency of dog walkers and general users was acknowledged when considering the proposed location and accounting for the size of the reserve that these users could co-exist with an appropriate design. The skate space will be located as far as possible from the active path and sporting reserve, and will include natural buffering with trees, greenspace and logs. The skate park in Leederville caters to older and more advanced skaters, this skate space will cater towards younger children and entry-level skaters. The proposed location also contains limited vegetation and is used for the City to store mulch, and would look to increase the natural greenspace and trees surrounding the area.</p>
<p>The existing pathway around Britannia reserve will have increased traffic of skateboards and scooters. I don't see it as a problem as it is a logical extension of the placement of the skatepark. It could however potentially be a source of conflict with other users of the path.</p>	<p>The active footpath is not in the project scope, however note this comment for reserve considerations and if regular conflicts emerge following its implementation then will look at measures to alleviate this.</p>
<p>Good location for siblings of other kids playing sports.</p>	<p>Noted.</p>
<p>No</p>	<p>Noted.</p>
<p>Not to replace the bmx place to keep bmx and skateboard separated</p>	<p>The proposed skate space location will not affect the pump track.</p>
<p>Closer toward existing carpark</p>	<p>Noted.</p>
<p>Yes. See responses through other questions.</p>	<p>Noted.</p>
<p>I think this will be great for the youth in the area</p>	<p>Noted.</p>
<p>I just pray it doesn't end up like the one in Leederville where I have seen drug dealings happen on several occasions</p>	<p>Noted.</p>
<p>It's quite isolated; skate parks are normally towards the edges of the reserve foot easier access.</p>	<p>Noted.</p>
<p>It would be a shame to lose the gravel small pump track for the younger kids. There are skate parks close by. The park is full of dogs & kids, always. It feels a bit hectic.</p>	<p>The proposed skate space location will not affect the pump track.</p>
<p>Should happen as soon as possible</p>	<p>Noted.</p>
<p>Good idea</p>	<p>Noted.</p>
<p>I approve of Britannia as a location but believe it should be in an area that can be surveilled easily. The 'walk' to the current location is off putting for those who simply want to watch their kids scooter / skate and will be an impediment for some. I think having the area able to be readily and easily surveilled will encourage a mix of ages to attend, including adults, and in doing so will discourage antisocial behaviour. Where it's done right? Look at how the Perry Lakes skate park is situated, close so parents can 'park up' and be watching but also lovely and close to easily hop out and sit on lawn/seats right there. I understand it needs to be sufficiently away from homes due to noise issues so either the corner where basketball hoop (to be moved of course, not removed) near tennis courts or between back of Athena and the cricket club roomson MH side would allow easy access and room for a row of parking 'to face' the skate park for easy surveillance/attendance.</p>	<p>Families and parents already ride and walk with their young children to the pump track and mountain bike trail, and the intention to then co-locate the skate space would be to allow them to sit and watch/interact with them across the added infrastructure. The proposed location was deemed preferable based on the clear sightlines to the area from across the reserve and frequent use resulting in good passive surveillance.</p>
<p>Make this area for multiple age groups with a playground attached for families</p>	<p>Noted.</p>
<p>There is dog poo all over that oval. In the last few years it has become one giant toilet for dogs, particularly around the edge of the car park near the cricket club.</p>	<p>Noted.</p>
<p>Make it epic and suitable for children aged 3-17 years of age.</p>	<p>Noted.</p>
<p>Great idea for the kids and teenagers</p>	<p>Noted.</p>
<p>There is too little detail about the project - as usual eg., what age range will this cater too?</p>	<p>The skate space will be designed to cater primarily to young children and 'twens', however will be considerate to enable any age or ability of skater to use the facility.</p>
<p>What else is the City planning to force on to Britannia Reserve users? Enough is enough! The area is being completely ruined as a community space for all ages as users have to now compete for space. It is already too dangerous for the elderly users to walk on the paths because of e-scooters, skate boards, bikes, roller blades and even recently a trail bike cutting across the Reserve!</p>	<p>The design will include a natural buffer zone between the pump track and the proposed skate space location. It will also be designed to complement the current wheeled sport amenities, and be small-scale to suit similar user demographics.</p>
<p>How is the skate space going to work with toddlers on trikes on the pump track?</p>	<p>The proposed location was deemed preferable based on the clear sightlines to the area from across the reserve and frequent use resulting in good passive surveillance.</p>
<p>How will the anti-social behaviour in the space be managed by the City? Simply ignored as usual?</p>	<p>The skate space will be designed to suit younger children and entry-level skaters, which will result in smaller scale skateable elements.</p>
<p>Britannia Park already consists of a huge green for kids to play on, two playgrounds as well as two pump tracks.</p> <p>There are areas within mount hawthorn for primary school kids with no kid friendly areas whatsoever. Instead of filling up Britannia park maybe consider making the area between Brady street and Jugan Street more family and kid friendly.</p>	<p>The intention of the proposed location, is to co-locate two small scale amenities together to create a 'youth hub' in this area of the reserve. Various parks/reserves around Mount Hawthorn and North Perth were identified, however Britannia Reserve was the preferable site to achieve the best outcome of facility and environment.</p>

Hopefully it won't reduce the pump track that's there	The proposed skate space location will not affect the pump track.
Its a good spot. Just need to ensure the safety of skaters and dogs with some sort of separation	Design related submission noted for consideration.
Create an accessible path for emergency vehicles, injuries can occur easily and quickly.	There is vehicle access to the reserve near the sports club room.
Brittania is already busy from people coming from other suburbs to use. also there are 2 other skate parks close by in Leederville and Cambridge. Many people from other areas of Vincent want a skate park close to them as there is nothing exists close to them it seems you are doing what is convenient for the council not in best interest of all residents	Noted.
Fence the whole place up	Design related submission noted for consideration.
Excellent addition to the Mt Hawthorn community :)	Noted.
I think it's a suitable space	Noted.
This space must be accessible for little kids as well as more advanced skaters.	Noted.
Should be readily accessible, close to transport and facilities, toilets / food / drink and not an isolated spot which could become a hazard at night.	Noted.
Good location as any.	Noted.
Makes total sense	Noted.
Disappointed in the lack of outdoor spaces that welcome young girls. Let's face it, most pump tracks, skate parks have a majority male following.	Noted.
Looks like a great choice	Noted.
Sounds great	Noted.
Good location, as long as it doesn't take space away from the existing bike tracks	Noted.
Ensure enough lighting	
Great location with good existing facilities for bikes and families	Noted.
I think its a much needed facility for our City's young people. I would like to stress the need for shade though please, a great park with no reprieve from the searing sun is an under-utilised one. Also a drink fountain, more shade trees, and some bench seating close to the park area please. The current pump track we use once a week even in winter, and a couple of bench seats or picnic tables close by would improve the space for us poor parents :) Thank you, great initiative CoV.	Design related submission noted for consideration.
Yes, a court for roller hockey pls	Due to varying constraints, unfortunately this will not be possible for this project.
Make it indoor	Due to varying constraints, unfortunately this will not be possible for this project.
Concerned to close to junior bike area. Families sit and have lunch etc there. Skateboards can be annoyingly noisy	Design related submission noted for consideration.
There is a skate space at Leederville. How many do we need in leederville. Great location, not close to the street and far away enough from houses	The skate park in Leederville caters to older and more advanced skaters, this skate space will cater towards younger children and entry-level skaters, and location is more approachable for families to use it along with the other features in the reserve.
Yes a great use of unused space and great to see it being updated to meet the times and provide for the growing families in the area	Noted.
Could be closer to parking facilities	Noted.
Great use of space. Covered seating would be great for carers.	Design related submission noted for consideration.
Perfect access for local kids	Noted.
No	Noted.
It is an unused area that would be perfect for a skate space.	Noted.
I'm not opposed as it's a good spot for a number of reasons. However, two concerns: skating kids will most certainly use the footpath to ride their skateboards to the facility regardless of signs or any kind of enforcement. This will create issues with pedestrians, kids on bikes and dogs. How do you propose managing this? And judging by the number of Facebook comments, there are similar facilities nearby. Have other locations been considered and reviewed (Charles Veryard, etc.)?	The high frequency of dog walkers and general users was acknowledged when considering the proposed location and accounting for the size of the reserve that these users could co-exist with an appropriate design. The skate space will be located as far as possible from the active path and sporting reserve, and will include natural buffering with trees, greenspace and logs. Various parks/reserves around Mount Hawthorn and North Perth were identified, however Britannia Reserve was the preferable site to achieve the best design outcome and value to the community.
Thrilled to have a skatepark in neighbourhood. Shame the location is so small therefore will offer limited skating features to accommodate range in ages using the facility. Understand challenges in finding a location.	Noted.
This location links extremely well with the currently overcrowded new pump track at Lake Monger	Noted.
It needs to be a bit of a destination otherwise its over in the 'corner' by itself. Like other Skate Sculpture projects it should include gazebo shelters and other activation items to attract people to make it feel lively.	Design related submission noted for consideration.
I support the proposed location - it seems entirely appropriate.	Noted.
YIPPEEE! Me and my kids (who skate) are stoked!	Noted.
Perfect Spot!!!!	Noted.
Extensive consultation. Don't want to lose more green space. Make sure site is within under utilised space. Doesn't make sense so close to Leederville. Already a lot of amenities. If goes ahead more greenery.	Design related submission noted for consideration.
Sloppy back & spine included. Simple is good.	Design related submission noted for consideration.
Great to be near bikes. Not near residential which is good.	Noted.
Concerned about view from surrounding residents. Don't want to look at concrete but want to continue looking at landscaping. Have natural elements incorporated where possible.	Design related submission noted for consideration.
There are already too many uses for the Britannia reserve	Noted.
The bike pump track has been fantastic. Another great initiative.	Noted.
Next to the bike area is good. Does it get coverage from the new lights?	It will only get limited lighting from the sports lighting, this is intended due to catering towards younger aged children and not enticing late night activity in this location.
Would prefer if the lighting is turned off by late evening to discourage late-night use and the associated noise from skateboards and youths hanging around.	Noted.
The impact of the independent elderly residence, the young families with children and the off lead dogs by having unsupervised Youths is reckless. Putting the safety of our community at risk.	The high frequency of dog walkers and general users was acknowledged when considering the proposed location and accounting for the size of the reserve that these users could co-exist with an appropriate design. The skate space will be located as far as possible from the active path and sporting reserve, and will include natural buffering with trees, greenspace and logs.
The City of Vincent has already (2) two skate parks already - Leederville and Lake Monger. Another skate park is not required - Money can be used elsewhere.	The Town of Cambridge recently opened their Lake Monger Pump Jump Track, however this is not the same facility. This proposed skate space will be designed towards younger children and entry-level skaters, and will enable them to develop their skills and eventually transition to the Leederville Skate Park and other more advanced skate parks.

I would prefer to keep Britannia as it is as it is relatively peaceful for walking around and feel the skate park would do a lot of noise at all times of day.I think a much better location would be the small patch of grass behind the stadium next to the mulch supply.It is a bit of a waste ground .There are also less houses nearby for noise impact.	The high frequency of dog walkers and general users was acknowledged when considering the proposed location and accounting for the size of the reserve that these users could co-exist with an appropriate design. The skate space will be located as far as possible from the active path and sporting reserve, and will include natural buffering with trees, greenspace and logs. The proposed location was preferred by the project Working Group to complement the existing amenities and co-locate with them at the site, attracting the same user demographic that already use the pump track and mountain bike trail.
Great spot for it, not too close to residents is great	Noted.
Please dont cut down any trees	Noted.

QUESTION 4: Would you foresee this proposed skate space location impacting on your current activities at Britannia Reserve?	
Submitter Comments Verbatim	Administration Comments
No add long as the cricket ovals are not impacted	The proposed location will not impact the current cricket activities.
No	Noted.
Impacting in a positive way in that I would visit more often in the future.	Noted.
Yes I think it will mean lots of over 12s cycling on the footpath and causing harm to walkers/dogs /younger children	The active footpath is not in the project scope, however note this comment for reserve considerations and if regular conflicts emerge following its implementation then will look at measures to alleviate this.
No	Noted.
Yes, i'd see it as positively improving current activities by providing facilities for more people to use and engage with the reserve. More people utilising reserves/public spaces creates better atmosphere.	Noted.
No, even though I walk regularly past the area.	Noted.
No	Noted.
No	Noted.
Negative at night,okay thru the day but not the best location	Noted.
Only in a positive manner.	Noted.
No. However, with the number of dogs being regularly exercised at the park, there would need to be some sort of fence to ensure they are kept out of the skatepark.	Design related submission noted for consideration.
No, it's a great compliment to the pump track and tennis courts	Noted.
No.	Noted.
no	Noted.
No	Noted.
The more activation the better!	Noted.
would be using it as it's closer than our usual skateparks	Noted.
Yes, in a positive way.	Noted.
No	Noted.
Absolutely not, I think it'd be fantastic	Noted.
Yes definitely. We would not be able to take our dog to the park as she is frightened of skateboards	Design related submission noted for consideration.
yes, I am an elderly lady and my safety, when walking in the park, is already threatened by skate boarders, scooters and cyclist all speeding through - this is already a dangerous walk - and will obviously get much worse. I live very close to this area and am surprised that those of us living in this area have not been consulted.	The high frequency of dog walkers and general users was acknowledged when considering the proposed location and accounting for the size of the reserve that these users could co-exist with an appropriate design. The skate space will be located as far as possible from housing, and will include natural buffering with trees, greenspace and logs. The skate park in Leederville caters to older and more advanced skaters, this skate space will cater towards younger children and entry-level skaters. The active footpath is not in the project scope, however note this comment for reserve considerations and if regular conflicts emerge following its implementation then will look at measures to alleviate this.
No	Noted.
Increase how often we visit as kids grow and are confident enough to ride it on their bikes or scooters	Noted.
No	Noted.
Question is rather: What value would the proposed skate space add to my family's current activity at Britannia Reserve? Answer: Zero	Noted.
No	Noted.
Not at all	Noted.

No	Noted.
No	Noted.
Not negatively, we'd probably be there more frequently	Noted.
Not at all, only encourages use of the space	Noted.
As above - i do hold concerns for dogs that might go onto the skate park lured by food, kids or fast-moving scooters and skateboards and get injured.	Design related submission noted for consideration.
Definitely.	Noted.
Not really but some logs around to deter the dogs running thru as this could be dangerous for the kids	Design related submission noted for consideration.
No how many boring ovals does this region need	Noted.
Yes, it will have a negative impact on the current regular park users due to the noise that skate parks create.	Design related submission noted for consideration.
Potentially yes. If older kids frequent it then it becomes a space for anti social behaviour after dark when younger kids have sports training. If there isn't adequate safe separation, it would limit the off lead activities for pet owners.	Design related submission noted for consideration.
Will visit more with kids on scooters if it accommodated entry level obstacles	Noted.
Yes. I would likely clash with use of the area for dog exercise and walking.	The proposed location is currently used for the City to store mulch, and would look to increase the natural greenspace and trees surrounding the area. The high frequency of dog walkers and general users was acknowledged when considering the proposed location and accounting for the size of the reserve that these users could co-exist with an appropriate design. The skate space will be located as far as possible from the active path and sporting reserve, and will include natural buffering with trees, greenspace and logs.
No.	Noted.
No	Noted.
No	Noted.
It would improve the time we spend their with our children and dog	Noted.
I would for sure go more often with my kids to practice skateboarding.	Noted.
No	Noted.
Yes. This is already a well used park by many sporting groups etc. It can often feel crowded so I use this space to exercise.	Noted.
No	Noted.
No	Noted.
Not unless the pump track is going to be removed to accommodate it; this is still very popular	The proposed skate space location will not affect the pump track.
Yes, as above. Skateboards etc using the same paths as dogs, small kids, bikes.	Noted.
No	Noted.
No, great addition	Noted.
No	Noted.
N/a	Noted.
No not at all, it would enhance the reserve	Noted.
It will take away space from where the dogs can defecate	Noted.
It would add to the facilities.	Noted.
No - in fact I will enjoy watching them skate and no doubt my grandkids would also use it.	Noted.
Yes I rarely go to Britannia as there is a park much closer to my house but would love another option to skate at other than the footpath.	Noted.
No	Noted.
Yes, as this is yet another ill-considered vote catching exercise that once installed won't be properly managed by the City.	The high frequency of dog walkers and general users was acknowledged when considering the proposed location and accounting for the size of the reserve that these users could co-exist with an appropriate design. The skate space will be located as far as possible from housing, and will include natural buffering with trees, greenspace and

What about the nearby elderly residents? What is the City doing for them other than make the Reserve too dangerous for them to use?	logs. The skate park in Leederville caters to older and more advanced skaters, this skate space will cater towards younger children and entry-level skaters. The proposed location also contains limited vegetation and is used for the City to store mulch, and would look to increase the natural greenspace and trees surrounding the area.
No	Noted.
No	Noted.
No	Noted.
Only that we might use it with our toddler. Alternatively we will have to keep our dog away whe we walk at Britannia	Noted.
Some concern re small kids on skateboards not staying within park and interacting with pedestrians and dog on walk path	Design related submission noted for consideration.
no	Noted.
No	Noted.
Yes already I'm driven off the path when I walk daily by bikes As an older person the path was originally supposed to benefit the older age group.	The active footpath is not in the project scope, however note this comment for reserve design considerations and if regular conflicts emerge following its implementation then will look at measures to alleviate this.
Not if it's fenced	Design related submission noted for consideration.
Yes	Noted.
No	Noted.
No, I do not foresee this proposed space impacting on my current activities at Britannia Reserve	Noted.
No	Noted.
No	Noted.
Hopefully not. Use it primarily to exercise dog. Only thing that could impact is if my dog decides to visit the skaters and gets in the way!	Design related submission noted for consideration.
Only to add value.	Noted.
No but we just wouldn't go there with our kids. Do you know how many kids this would service? And aren't kids in this group already well serviced by nearby parks? Could a series of half netball/ bball/ tennis/volley/badminton courts attract a much wider usage?	The skate space has been funded by the State Government to address community feedback towards the shortage of skateable infrastructure that caters to younger children. The City have recently upgraded a number of nature playgrounds, and are always interested to hear from the community on what other facilities/amenities they would like to see in their local area.
It would improve my families activities there, and my own	Noted.
No, the proposed facility will be adding amenity the the current Britannia Reserve along with the current oval and playgrounds.	Noted.
It would give me another reason to use the park	Noted.
Not at all. It is essential that facilities that meet the needs of our young citizens are provided. As a group, we will all reap the benefits.	Noted.
No impact as long as it doesn't take space away from bike tracks	The proposed location will not impact the current pump track or mountain bike trails.
No only would increase our uso	Noted.
Not at all, it will be great for the community	Noted.
No, only an improvement, better use of space, more people outdoors!	Noted.
Yes, I would increase my visitations	Noted.
not at all	Noted.
No	Noted.
Yes if they skateboard along path to get there. Skateboards, dogs, elderly and prams don't mix	The active footpath is not in the project scope, however note this comment for the reserve consideration and if regular conflicts emerge following its implementation then will look at measures to alleviate this.
Yes. Although there would be a skate park you will find people will stake on the path to get there. Unfair for older people and dogs.	The active footpath is not in the project scope, however note this comment for the reserve considerations and if regular conflicts emerge following its implementation then will look at measures to alleviate this.
It will add another use to the reserve for young people which is good	Noted.
Only in a positive way, plus there is plenty of park still available to dog walkers if they are worried, the the reserve should be shared.	Noted.
This would definitely make our family use the public space more often.	Noted.
No	Noted.

It would not affect our use of the pump track or running around the footpath loop. I believe our family would also use this facility	Noted.
No.	Noted.
No	Noted.
No	Noted.
No	Noted.
No absolutely not. It would enhance my family's activities.	Noted.
See above. Just general noise and kids skating on the footpaths to get there.	Noted.
No it is located away from other sporting facilities.	Noted.
No negative impact, only positive. Adds another terrific activity space to a great community location.	Noted.
Yes, as my child grows I will encourage use of a skate space.	Noted.
Increase in noise, what age group is this skate park aimed at? Under twelves not so bad. Over 12 Definley not.	The proposed skate park will be designed to cater towards younger children and include entry-level skate elements that will be much smaller than at Leederville Skate Park, however would still anticipate usage from a range of other demographics, particularly in the short term following construction.
Not in a negative way.	Noted.
It will mean we will be coming down here a lot more and take our dogs.	Noted.
No, It's so small people would hardly feel the impact.	Noted.
Yes, as it will bring more people to the area. Will be negative if impacts natural view and tranquility.	The skate space design will include consideration to the current surrounds and incorporate appropriate landscaping to integrate the provision into the reserve.
Yes, would come to skate.	Noted.
No, dog walker	Noted.
Yes negativity if can see lots of concrete.	The skate space design will include consideration to the current surrounds and incorporate appropriate landscaping to integrate the provision into the reserve.
No, I walk my dog around that area but generally stay on the path	Noted.
Yes. There are already too many activities within the park which is extremely noisy from pre dawn to well after dark, not to mention the light pollution. It no longer has aesthetic value.	Noted.
No, it would be great for kids	Noted.
No	Noted.
No.	Noted.
No	Noted.
Please tell me when and how you have gathered support for this proposal. This is too much. Please show some respect for the residents on the park.	The skate space has been funded by the State Government to address community feedback towards the shortage of skateable infrastructure that caters to younger children and entry-level skate abilities. The skate space is viewed to complement the existing features at the reserve for families and children to interact with.
Noise - screaming - graffiti - Drug Use and dealing - such as Leederville!	The skate space will be designed to cater primarily to young children and 'tweens', however will be considerate to enable any age or ability of skater to use the facility. The design will include a natural buffer zone between the pump track and the proposed skate space location. It will also be designed to complement the current wheeled sport amenities, and be small-scale to suit similar user demographics. The proposed location was deemed preferable based on the clear sightlines to the area from across the reserve and frequent use resulting in good passive surveillance.
Yes.	Noted.
No	Noted.
No	Noted.



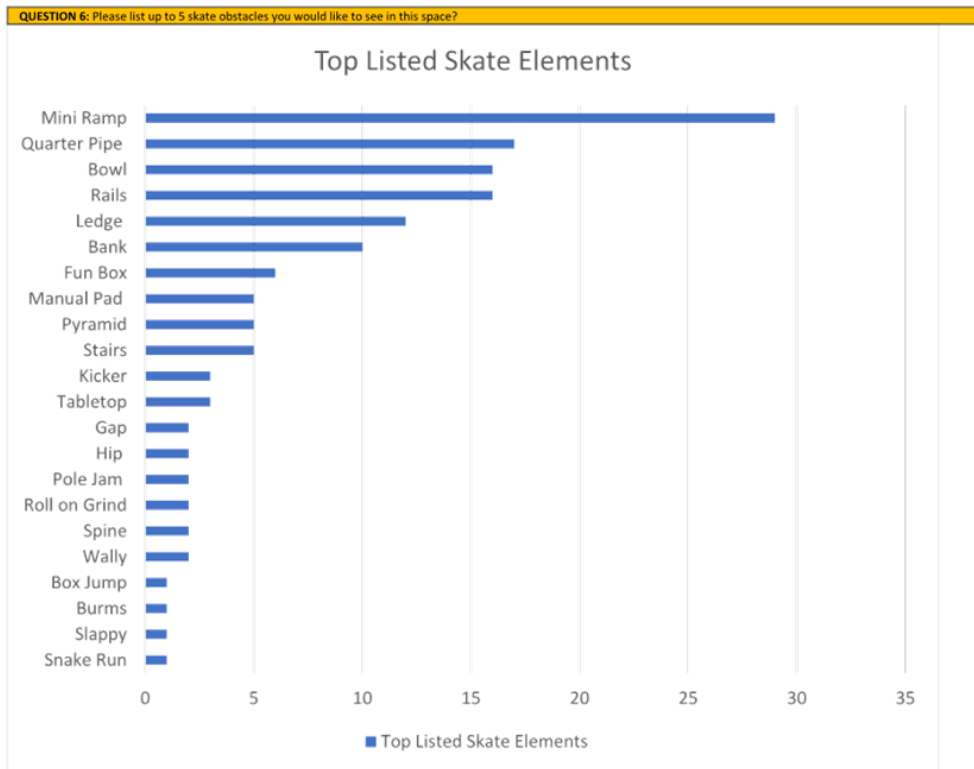

QUESTION 7: Do you have any other comments on the location or design aspect of the skate space?

Submitter Comments Verbatim	Administration Comments
No	Noted.
make accessible to all age groups, focus on younger given older kids already have Leederville and the new one at lake monger	The proposed skate park will be designed to cater towards younger children and include entry-level skate elements that will be much smaller than at Leederville Skate Park, however would still anticipate usage from a range of other demographics, particularly in the short term following construction.
No thank you.	Noted.
I support a skate park, just question the proposed location right in middle of the reserve	Noted.
Design would ideally be suitable for a range of ages and abilities	The proposed skate park will be designed to cater towards younger children and include entry-level skate elements that will be much smaller than at Leederville Skate Park, however would still anticipate usage from a range of other demographics and abilities.
As long it is big enough to cater for a variety of ages using the facility	The proposed skate park will be designed to cater towards younger children and include entry-level skate elements that will be much smaller than at Leederville Skate Park, however would still anticipate usage from a range of other demographics and abilities.
I think this will be an awesome addition to britannia!	Noted.
Shaded seating areas would be great, as well as a drink fountain (with a bottle refill tap). Local artists should be asked to paint the skatepark.	Design related submission noted for consideration.
Closer to the mezz and Leederville have a skate park, a bus service close by would help teenagers get there and not walk along a dark bike path to get there	The proposed location was preferred by the project Working Group to complement the existing amenities and co-locate with them at the site, attracting the same user demographic that already use the pump track and mountain bike trail.

	This proposed skate space will be designed towards younger children and entry-level skaters
Please keep roller skaters in mind when designing the park, not just skateboards and scooters, thanks.	Noted.
Needs lights and also smaller obstacles where kids can build confidence on.	Design related submission noted for consideration.
do it now!	Noted.
two tone concrete!	Design related submission noted for consideration..
Get skaters to design it.	Noted.
I think the location is perfect, far away from houses for potential noise but also great for parents to keep an eye on their kids	Noted.
Please place it away from Britannia oval.	The proposed location was preferred by the project Working Group to complement the existing amenities and co-locate with them at the site, attracting the same user demographic that already use the pump track and mountain bike trail.
I thought we already had a skate park near the train station - why do we need another?	The proposed location was preferred by the project Working Group to complement the existing amenities and co-locate with them at the site, attracting the same user demographic that already use the pump track and mountain bike trail. This proposed skate space will be designed towards younger children and entry-level skaters, and will enable them to develop their skills and eventually transition to the Leederville Skate Park and other more advanced skate parks.
There should be adequate signage that this is for skateboard/scooter use only - to avoid hazards of toddlers or children not on scooters playing in the area.	Design related submission noted for consideration.
I would think about how to differentiate it from the one at Leederville and make that a key design goal. It would be good to have some obstacles for beginner-intermediate skaters/bikers as well as some for more advanced with progression so kids can build their skills. I'm likely dreaming but it would be great to upgrade the pump track to a proper one so it serves as a complementary asset to the skate park more focussed on bikes. The current pump track isn't fit for purpose. The kids are still building jumps at the north end of the park because you can't jump anything in the pump track.	The proposed skate park will be designed to cater towards younger children and include entry-level skate elements that will be much smaller than at Leederville Skate Park, however would still anticipate usage from a range of other demographics and abilities.
Adequate night lighting Adequate Shade Water fountain Benches Litter bins Distance from parking is a plus and minus - will keep it more for locals, but may increase the foot traffic (and skaters) on the access paths to the skate park itself.	Design related submission noted for consideration.
Find another site in the City of Vincent that does not already have two nearby.	The proposed location was preferred by the project Working Group to complement the existing amenities and co-locate with them at the site, attracting the same user demographic that already use the pump track and mountain bike trail. This proposed skate space will be designed towards younger children and entry-level skaters, and will enable them to develop their skills and eventually transition to the Leederville Skate Park and other more advanced skate parks.
We visited the one in Miami on the Gold Coast recently which was very impressive that might offer some design ideas.	Noted.
- being remote from other facilities, is there a likelihood of poor behaviour or vandalism?	The proposed location was preferred by the project Working Group to complement the existing amenities and co-locate with them at the site, attracting the same user demographic that already use the pump track and mountain bike trail.
Would love to see separation of the older obstacles from the younger ones for safety and allowing the older kids/adults a space to safely take risks without fear of hurting younger users. The Albany skate park is an amazing example of this separation with something for younger users, medium obstacles for mid range and then advanced obstacles for older/advanced skills	The proposed skate park will be designed to cater towards younger children and include entry-level skate elements that will be much smaller than at Leederville Skate Park, however would still anticipate usage from a range of other demographics and abilities.
A very pleasant idea for a suburb that is appealing to youth and families. Will bring young people to central areas and cultural hubs	Noted.
Use another area in Vincent	The proposed location was preferred by the project Working Group to complement the existing amenities and co-locate with them at the site, attracting the same user demographic that already use the pump track and mountain bike trail.
Similar to perry lakes would be great	Noted.
Would be nice to fix the kids pump track while you are at it	Noted.

<p>This is much too close to the Leederville Skate Park. Please do not ruin our peaceful enjoyment of Britannia Reserve. A lot of elderly people and dog owners seek out a quiet peaceful experience there on a daily basis. It is one of the only large green spaces left around here. If you put in a skate park it will detract from this and you may see a number of local residents using it less. Please don't forget that there is a retirement village next to this park too. Thank you.</p>	<p>This proposed skate space will be designed towards younger children and entry-level skaters, and will enable them to develop their skills and eventually transition to the Leederville Skate Park and other more advanced skate parks.</p> <p>The skate space is viewed to complement the existing features at the reserve for families and children to interact with. The skate space design will include consideration to the current surrounds and incorporate appropriate landscaping to integrate the provision into the reserve.</p>
As above	Due to varying constraints, this will not be possible for this project.
Good location for more youth amenity but not sure if skatepark is in demand.	Noted.
By their nature they are usually a heat sink. Trees unfortunately do not form a good fit due to debris and consequent accidents from wheels jamming on nuts, twigs etc. Some shade in a suitable spot would be good, maybe seasonal shade sails to extend the life of them. Water fountain if possible. Seating for parents, maybe raised for visual observation over the skatepark and the small bike track incorporated into an adjoining nature scape area which would have multiple benefits and uses.	Design related submission noted for consideration.
Aim at complete beginner to intermediate or primary school age. have some kind of seating for parents and carers.	Design related submission noted for consideration..
<p>It would be great to see construction of a wider (less narrow) skate space, rather than a 'skate path'. While I understand that the intention of parks of this 'path' style is to channel movement in one of two directions in an up/down flow, this layout often causes conflicts of use between beginner and more advanced users.</p> <p>As such, I believe that a 'squarer' slab arrangement (such as Crimea Skatepark in the City of Bayswater) will facilitate more freedom of movement around the space, allowing beginners, intermediate and advanced riders alike to pick and choose their 'lines' in a way that minimises conflict.</p> <p>Noting the area constraint of 300m², I believe that dimensions in the order of 25m long by 12m wide would strike the right balance between channeling flow and allowing freedom for riders to choose their own lines around the space.</p> <p>Thank you!</p>	Design related submission noted for consideration.
<p>3 different levels :</p> <p>Beginner</p> <p>Intermediate</p> <p>Pro</p> <p>+ covered area would be perfect for hot or rainy days</p>	Design related submission noted for consideration.
If it could be designed to be multi use	Design related submission noted for consideration.
Another concrete fixture in a beautiful green space that limits the use of the park by majority of the local population is not well thought out. It's a busy & well used park.	The high frequency of dog walkers and general users was acknowledged when considering the proposed location and accounting for the size of the reserve that these users could co-exist with an appropriate design. The skate space will be located as far as possible from housing, and will include natural buffering with trees, greenspace and logs. The skate park in Leederville caters to older and more advanced skaters, this skate space will cater towards younger children and entry-level skaters. The proposed location also contains limited vegetation and is used for the City to store mulch, and would look to increase the natural greenspace and trees surrounding the area.
No some good council skate parks around	Noted.
See above. Design and layout of Perry lakes is outstanding. Allows 'areas' for all abilities and is large enough to accommodate the very small, young scooters and those older and more adventurous and with higher skills at skateboarding/scooting to be separated into skill level areas.	Design related submission noted for consideration.
Attach a small play area for smaller children	Design related submission noted for consideration.
<p>I think this is brilliant and the kids are really lucky.</p> <p>Do the best consultation you can with regular users of skate parks and the kids.</p> <p>It's hard combining 4 year olds on scooters and 14 year olds on BMX but let the kids solve it, not the adults</p>	Noted.
Please just build it and let's get the kids off the street participating in a healthy activity.	Noted.
Please don't scrimp on budget do something decent like at Perry lakes. COV is way behind other councils ATM	Noted.
<p>Properly consult with the whole community, especially the residents of Leederville Gardens who will be most impacted by yet another high-impact eye sore on Britannia Reserve.</p> <p>Why is this consultation period so short? To push the proposal through?</p> <p>Who is benefiting from all of the money being spent on installations on Britannia Res, certainly not the whole community.</p>	<p>The comments and feedback collected from this 14 day preliminary consultation period was used to inform the development of the draft Concept Design. The properties within Leederville Gardens Retirement Village were provided letter notification of the survey, pop-up event and consultation period.</p> <p>Further formal consultation will occur following advice from Council.</p>

	The funding objective from the State Government grant is to construct a youth facility that will be catering towards families and young skaters that will be addressing a need outlined by the community.
As above	Noted.
Younger kid area and older kid area to separate speeds etc.	Design related submission noted for consideration.
It's badly needed in the area	Noted.
Again, would like to see some elevation of skaters and dogs using the park, for safety reasons it might need to be fenced.	Design related submission noted for consideration.
No	Noted.
If you proceed which I hope not as far away from homes as possible fenced with access from bush freeway side and not the footpath on the inside near the grass	Design related submission noted for consideration.
Skate park should be near the water corp and youth centre	This proposed skate space will be designed towards younger children and entry-level skaters, and will enable them to develop their skills and eventually transition to the Leederville Skate Park that is located next to the Leederville YMCA (and other more advanced skate parks).
No	Noted.
Because of isolation, evening / night time use might be limited for users as it may be unsafe.	Noted.
Maybe fenced to stop dogs being walked - getting into area and possibly getting hurt or causing an accident with skaters etc..	Design related submission noted for consideration.
The best part about pump and jump track is that it integrates with natural elements of park well. I'm sure it's harder to achieve for a surface suitable to skates - but would like to see this considered. Also would love to include integrated artwork. It makes it enjoyable for the kids - especially for the young ones - if there are different points of interest at different obstacles within the course/track. That helps when they are feeling challenged to learn a new skill. So fun designs - or better yet, artwork - that are also sympathetic to natural elements would get my vote!	Design related submission noted for consideration.
This funding has already been allocated and decided. I guess the teenage and younger girls can go hang out on tik tok and the shopping mall.	Noted.
Its a great idea	Noted.
Willeton skate plaza is a great example Similar elements please	Design related submission noted for consideration.
The council must ensure that this project doesn't impact on others who enjoy this park in various ways.	Noted.
Great ideal	Noted.
Great location and good to see COV looking to expand its skate facility options for the community! Please start building it soon 🙏	Noted.
Please include: A drink fountain. Trees & shade around the perimeter with seating for tired kids. My comments are on behalf of my family with young children. Thank you	Design related submission noted for consideration.
Yes, definitely look at a roller hockey court	Due to varying constraints, this will not be possible for this project.
Make it indoor with big fans on the roof	Due to varying constraints, this will not be possible for this project.
I can't see concept? I think it definitely must be limited to younger kids else they can go to the existing one at Leedy. Carpark at Aranmore Primary used at night often with music. Very annoying. Maybe up to 12 years old and not after 7pm.	The comments and feedback collected from this preliminary consultation was used to inform the development of the draft Concept Design. Further formal consultation will occur following advice from Council.
Not in a park. This park is busy at all times of the day and I foresee accidents on walking paths.	The skate space design will include consideration to the current surrounds and incorporate appropriate landscaping to integrate the provision into the reserve.
Do not put ramps close/squished together	Design related submission noted for consideration.
Great location next to the mountain bike track and so needed for an area with growing families and young kids	Noted.
Love that the council is continuing to improve the area	Noted.

Well lit, spaces to rest.	Noted.
Drinking water please nice and close to skate park	Design related submission noted for consideration.
No.	Noted.
It would be really awesome to have a skate space where we live :P	Noted.
Good to have some features for older kids with lighting available particularly weekend evenings, with consideration to toilet facilities open. Thank you ToV for always seeking new spaces for our kids :)	Noted.
Please don't do a half job! Do it right, make it amazing. Also please don't let antiquated views of a small minority (for whom a skate park would have next to no impact), derail positive projects like this that are valued by so many of all ages.	Noted.
Like other Skate Sculpture projects it should include gazebo shelters and other activation items to attract people to make it feel lively. The nature design that Skate Sculpture used in Forrestfield and Boddington would be good aesthetically.	Design related submission noted for consideration. Through the design phase, supporting infrastructure will be considered. The skate space design will include consideration to the current surrounds and incorporate appropriate landscaping to integrate the provision into the reserve.
No.	Noted.
Please do not use gravel, mulch, stones or trees/bushes that drop nuts surrounding the park and make sure the flat ground (concrete pad) level is higher than the grass level to assist sweeping debris off the park without it blowing back on.	Design related submission noted for consideration.
The more transition with coping the better.	Design related submission noted for consideration.
Keep natural elements.	Design related submission noted for consideration.
Good location.	Noted.
Include water feature.	Design related submission noted for consideration.
There are already so many activities within the park. Since I purchased the property abutting the park, off-lead dogs have been permitted throughout the park (constant yelling, whistling and clapping is heard from pre dawn to after dark), a path has been installed within metres of the property line, lights have been installed around the path, multiple organised sports are played, an off-road bike track was installed, enormous lights have been installed and are lit every night, the school uses the park for exercise sessions, and a technology tower is soon to be installed. Enough is enough!	The high frequency of dog walkers and general users was acknowledged when considering the proposed location and accounting for the size of the reserve that these users could co-exist with an appropriate design. The skate space will be located as far as possible from housing, and will include natural buffering with trees, greenspace and logs. The skate park in Leederville caters to older and more advanced skaters, this skate space will cater towards younger children and entry-level skaters. The proposed location also contains limited vegetation and is used for the City to store mulch, and would look to increase the natural greenspace and trees surrounding the area.
Toilet's please and the current playground would benefit of an uplift	Design related submission noted for consideration.
Can we please get some tables installed at Britannia Reserve? There are currently only a few benches, but no tables.	Design related submission noted for consideration.
Move to a more appropriate location for the youth's to have access to public transport ie near bus depot or train stop	The proposed location was preferred by the project Working Group to complement the existing amenities and co-locate with them at the site, attracting the same user demographic that already use the pump track and mountain bike trail. Distance to public transport was a consideration in the site selection process, the closest bus stop is on Britannia Rd at the north-east corner of the reserve.
YES. One is already going in Leederville - Another at Lake Monger - How many SKATE PARKS do you have to have.	The Town of Cambridge recently opened their Lake Monger Pump Jump Track, however this is not the same facility. This proposed skate space will be designed towards younger children and entry-level skaters, and will enable them to develop their skills and eventually transition to the Leederville Skate Park and other more advanced skate parks.
Move it to the above mentioned area next to the mulch patch.	Noted.
Please maintain pathway and trees!	Noted.



LEGEND

- 1 QUARTER PIPE (900H) WITH STEP DOWN AND POCKET BANK (900H)
- 2 BANK (900H)
- 3 PYRAMID BOX (400H) WITH RAIL (400H)
- 4 FLAT RIDE UP RAIL (250H)
- 5 TURN AROUND QP WITH POCKET (900H)
- 6 MINI RAMP (750H) WITH STEP DOWN END (450H)
- 7 SLAPPY BANK (750H) WITH MANUAL PAD (200H)

- 8 PUMP BUMP (450H)
- 9 LOG SEATING
- 10 GRASS HANGOUT
- 11 SHADE STRUCTURE WITH PICNIC BENCHES
- 12 EXISTING PUMP TRACK LOCATION



BRITANNIA LOCAL YOUTH SKATE SPACE
CONCEPT MASTER PLAN

0 NORTH

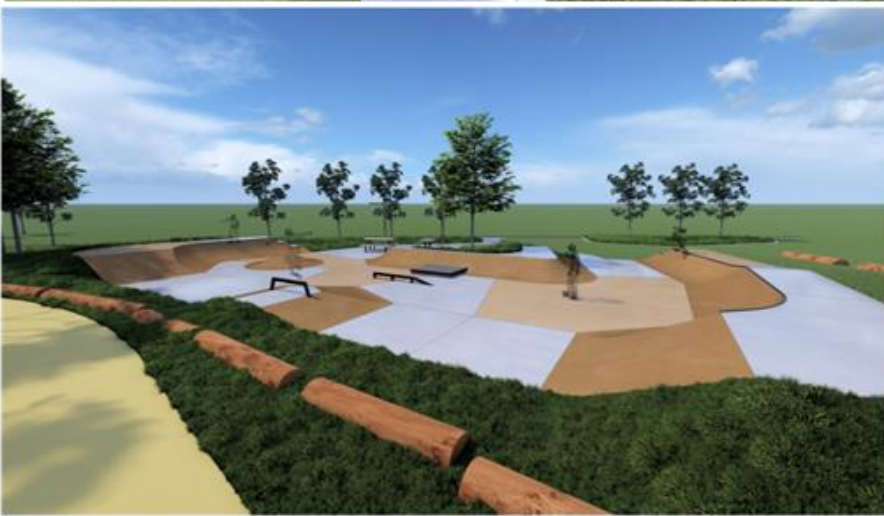

BRITANNIA LOCAL YOUTH SKATE SPACE
CONCEPT RENDERS





**BRITANNIA LOCAL YOUTH
SKATE SPACE
CONCEPT PERSPECTIVE -
ACROSS RESERVE FROM
NORTHERN CRICKET
PITCH**







**BRITANNIA LOCAL YOUTH
SKATE SPACE
CONCEPT PERSPECTIVE -
ACROSS RESERVE FROM
SOUTHERN CRICKET
PITCH**





Draft Concept Plan – Community Consultation Summary

Consultation Overview

Consultation on the draft Concept Plan was undertaken to confirm the design suitably reflects the community sentiment following the initial preliminary consultation period:

- The skate space design and skateable elements;
- The supporting infrastructure to encourage extended usage; and
- The surrounding landscaping for site integration.

The draft Concept Plan consultation commenced 19 October 2022 and closed 9 November 2022. The consultation campaign included:

- [Imagine Vincent](#) project page contained the online survey.
- Social media campaign and news item on the City's website.
- Postcard drop to residents in approximate 400m radius of the north west portion, including bordering residents along the south eastern boundary of the reserve (1377 postcards).
- Signage in Britannia Reserve.
- Pop-up session at Britannia Reserve (5 November 2022).

A summary of the consultation engagement includes:

- Survey Participants: 60 (54 online and 6 paper submissions)
- Email Submissions: 2
- Total Page Visits: 424
- Social Media Interactions (1 post): 41 reactions & 9 comments

Online Survey Results

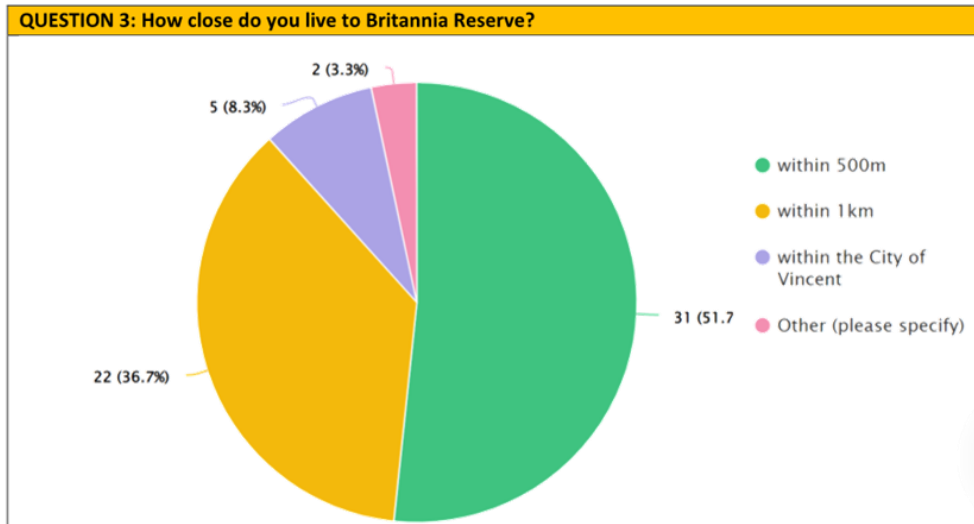

96.7% of respondents live within Vincent, with the majority living within 500m (51.7%) and 1km (36.7%) of Britannia Reserve.

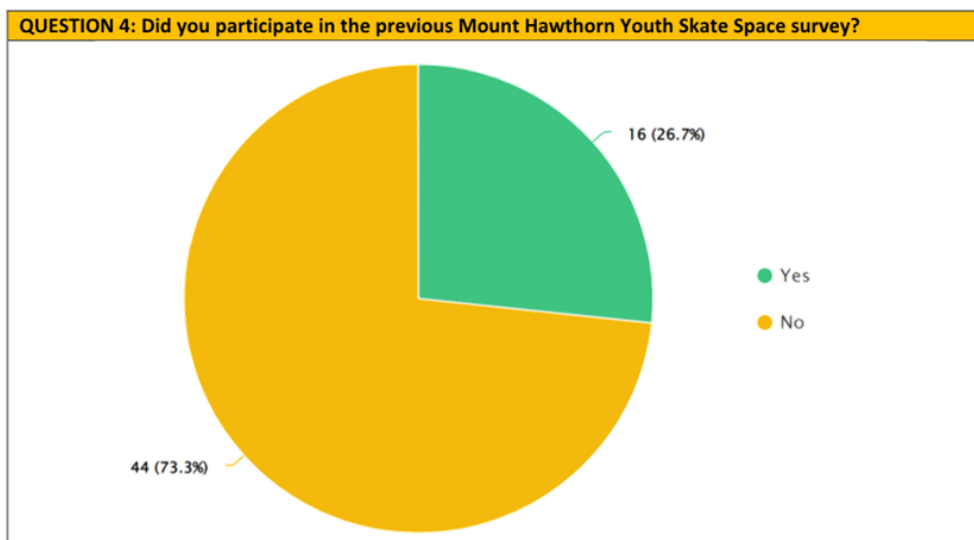

The majority of respondents (73.3%) indicated they didn't participate in the preliminary consultation survey.

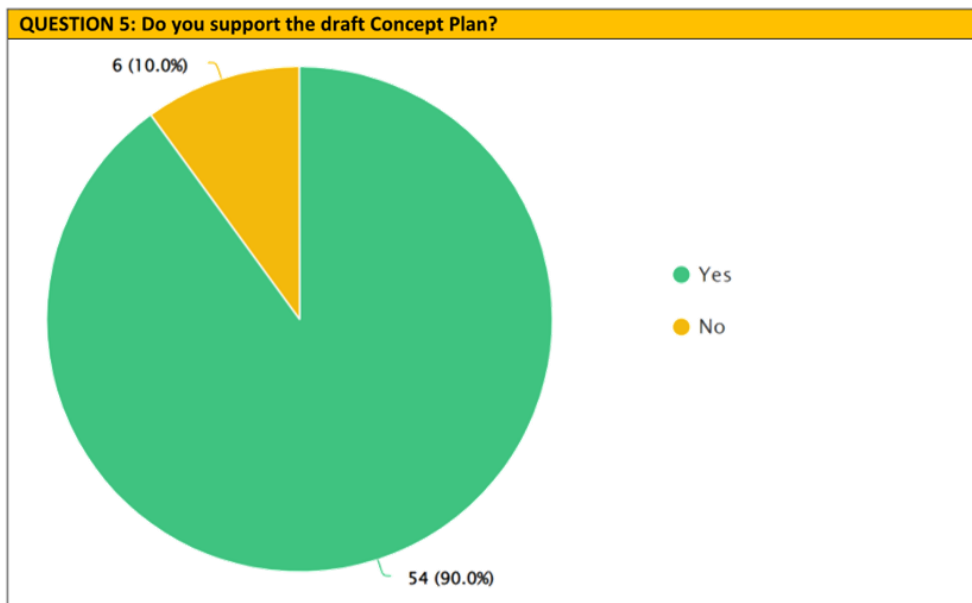

The 6 respondents (10%) who do not support the draft Concept Plan live within 500m of Britannia Reserve.

QUESTION 6: Do you have any comments on the draft Concept Plan?

Submitter Comments Verbatim	Administration Comments
Great initiative, this space is so lively and buzzing already, will make a great addition to the park	Noted.
My observation from recently taking the kids to the new skate park in Bunbury is that jumps and small drop offs were clearly the most popular feature. There were a few advanced kids doing big jumps in the skate bowl but the more populous younger and intermediate skaters and scooter riders were doing the small drop offs and tabletop style jump and testing themselves on different steepness ramps. It looks like you've got different steepness ramps but I don't see much in the way of jumps and drops which were probably the single most popular feature at Bunbury. So to me that looks like a big miss. There also doesn't appear to be any features for advanced riders, in fact it looks to me in the picture like a lot of quarter pipe and not much else.	The skate park consultant was engaged throughout the preliminary consultation period and designed the skate space to cater towards younger aged children and the scale of elements reflects being an encouraging environment for beginners. Its still anticipate usage from a range of varying demographics and abilities.
I love the that the heights proposed are at beginner levels.	Noted.
I hope all trees are preserved and new trees are added.	Noted.
I am in total agreeance with the design. Please make sure their are water outlets in the area for people to obtain drinking water	No water fountain has been included in the immediate area, however there are 3 water fountains within Britannia Reserve.
Just do it. we need more fun things for kids	Noted.
Think it would be great to create some "urban skating" obstacles like rails and boxes and table tops so that the space appeals to a wider variety of youth age groups and skill levels.	The skate space is of a compact nature and does contain obstacles such as rails and pyramid box with rail, along with a small manual pad. These were inclusions by the skate park consultant that were favoured in the initial consultation period and could be incorporated into the overall design.
It will be a nice addition to the space, we need more activation of areas like this for a wider range of age groups	Noted.
public toilets would be good as the club toilets are never open.	Britannia Reserve does have publicly accessible toilets within the sports club room building, these are managed by the City and are within walking distance to the skate space.
I find that the CoV have yet again, in Mount Hawthorn / Leederville, chosen to invest in amenities suitable for children. The target demographic for this park sounds to be circa 8 -12 year olds a period of 4 years of a child's life. Whereas the investment in something for older people seems not to be there. People are elderly and retired for much longer than just 4 years. The park will only be used for 2 days of the week, whereas an amenity for older people is much more likely to be used 5 days a week. Aranmore Junior already use the park next to the Rosewood aged care facility as their sports ground and recess space, meaning residents from there can't utilise that space.	The funding objective from the State Government grant is to construct a youth facility that will be catering towards families and young skaters that will be addressing a need outlined by the community in or around Mount Hawthorn. It is anticipated that it will be used most days of the week, especially during summer following daily commitments. The City always welcome suggestions and ideas to improve the provisions within our parks and public spaces to benefit all residents and users.

Britannia is often being used by the CEDA program and also Aranmore senior school. How about providing for those who have given us so much.	
More skate parks the better.	Noted.
the youth area should have a basketball court as it is very popular sport in the area	Noted. There are currently two basketball rings at Britannia Reserve, at the north-west section near Litis Stadium and southern end of Britannia Reserve.
Support	Noted.
It's a great idea for the youth at CoV and using space that is readily available.	Noted.
EXCELLENT PLAN OVERDUE	Noted.
Looks great	Noted.
Outstanding plan, love how we are truly activating the wonderful space at Britannia, awesome job!	Noted.
Looks good, well done	Noted.
I like the design and size, though should we not have at least one area / ramp for older children or experienced skaters. Also the colour scheme seems to stand out rather a lot - I see the look it is going for however I feel it could be even more attuned to the surrounding landscape. :-)	A skate park consultant was engaged throughout the preliminary consultation period and designed the skate space to cater towards younger aged children and the scale of elements reflects being an encouraging environment for beginners. Its still anticipate usage from a range of varying demographics and abilities.
Great that kids have more facilities in this multi-use Park. A quality facility such as this is necessary and then it should be looked after and valued by the users. It's close to the path without blocking anyone (not hidden away) and the facility will be good to look at as kids enjoy using it. The seating and shaded picnic areas are important for socialising.	Noted.
Great idea. Excellent facility for young people.	Noted.
an excellent idea - great for kids.	Noted.
I think Britannia is an ideal location for a skate park. I like the way it is adjacent to Britannia's open space, making it feel open and accessible, like the skate park in Fremantle. HQ in Leederville feels more enclosed and less welcoming.	Noted.
It looks good. Compact and thoughtfully designed. However are there lights and bins in the area?	Bins will be installed on-site. The skate space itself will not be lit, this is intended due to catering towards younger aged children and not encouraging late night activity in this location.
its my dog walking area, that section is not the best location for several reasons- mostly dogs off leash area, there's no parking, its a dodgy area next to freeway with poor lighting, the amount of loose dogs around concerns me, why not place it on the huge mass of land that Floreat Athena grounds use- to the south east of the old velodrome or. on the area between the car park for the footy club, this land is so under-utilised, and needs something on it, placing the skate park in the middle of a giant green oval and dog exercise area is not acceptable, I have kids that might use it but you MUST have car parking and toilets NONE of which are there- look at the lake monger developments- they have Greta toilets, easy parking and good visibility. this will invite crime, and to be honest as a parent of a small kid, I wouldn't want to walk over a huge grassed area to sit in the middle of an oval, with no loo nearby or water fountain or any amenity, seriously look at the areas around the foot club on Britanny's- its a shambles, disgrace, it must be improved, its an eye sore. thanks.	Dogs can be off lead at Britannia Reserve on the basis that they are under control at all times. The skate space will occupy only a area of 350sqm with the reserve allowing plenty of space for dog walking. The area to the south-east of Litis Stadium was identified, however has significant tree canopy would cause maintenance issues to the small wheels of skateboard, scooters and roller blades. The City are currently progressing the Britannia North West Development Plan to improve Litis Stadium (old velodrome) site and amenities. This location was preferred following site analysis, due to the size of the reserve would allow a skate space without immediately impacting current activities at the site. The site is currently used to store mulch for the City's parks operations.
We already have a skate park in the town center. This is a complete waste of money.	The skate park in Leederville caters to older and more advanced skaters, this skate space will cater towards younger children and entry-level skaters, and location is more approachable for families to use it along with the other features in the reserve.
I am a little concerned about the lack of shade around the skate park - with hard surfaces it may be too hot in summer during the day	The current mature trees surrounding the space will provide a number of shaded spots for families and skaters with turf surrounds to mitigate heat, along with the adjacent shade structure. It anticipated that during the summer season, usage would primarily occur in the morning and evening periods. The requirement for further shading in future will be monitored.
I think this is a great idea. That part of the park is not used much by dog walkers. It is really nice to see young families at this park space, and this will bring more.	Noted.
I understand that this park is aimed at children, though it is so unchallenging I can't imagine children over 3-4 years being kept interested by it. The drop ins are tiny, I can't see that someone could get enough speed up to attempt the bump or the bank. And, there is no big bowl - a skate park essential. Perhaps consider adding some more challenging elements, or altering what is already there.	A skate park consultant was engaged throughout the preliminary consultation period and designed the skate space to cater towards younger aged children and the scale of elements reflects being an encouraging environment for beginners. Its still anticipate usage from a range of varying demographics and abilities. Acknowledging a big bowl is a popular element, however this is featured at the nearby Leederville Skate Park.
We are excited about it.	Noted.
Great to see the council doing something for our kids	Noted.
I support the idea of a skate park. I think the skate park and the pump track should be located closer to the car park &/or cycle track access from the freeway. When young cyclists/skaters & pedestrians use the same access pathway, there is a risk of injury. Cyclists are sometimes insensitive to older users not being able to hear them or take evasive action and there are many	The active footpath is not in the project scope, however note this comment for reserve considerations and will be monitored following the construction

older users due to the nearby residents and facilities. It would be a shame to ruin the experience of older users for younger users.	of the skate space. If regular conflicts emerge following its implementation then will look at measures to alleviate this.
Good spot to have it next to the bump track.	Noted.
Good idea. Far enough from residential premises and near the bike path. Important location for kids around the higher density living areas that border Britannia park. A good use of the noisy corridor along the highway. I would like to see the trees preserved at much as possible including during construction. Likely need to along for additional graffiti management on adjacent buildings. I recommend having a sign or painted on the bike path the direction and distance to public toilets.	Noted. The draft Concept Plan has been designed to limit its impact on the current vegetation, no mature trees will be impacted and provision for additional planting has been included.
Ensure maximation of shaded area, include a drink fountain and ensure a suitable run on area at the start.	Noted.
We believe that it is very important to create informal recreation active spaces such as this skate park for young people in a safe environment. As housing density increases, this becomes even more important.	Noted.
Good for younger kids. Can't think of anything better. Good to get kids out & about	Noted.
I think it looks great and a wonderful idea.	Noted.
Great Idea!	Noted.
Total separation from footpath. Speed limits displayed for bikes on footpath. Large trees for shade on the other side of path. Also this will allow nesting feeding for parrots, kookaburras.	Noted.

QUESTION 7: Do you believe the skate elements included are suitable for younger children and entry-level skaters?

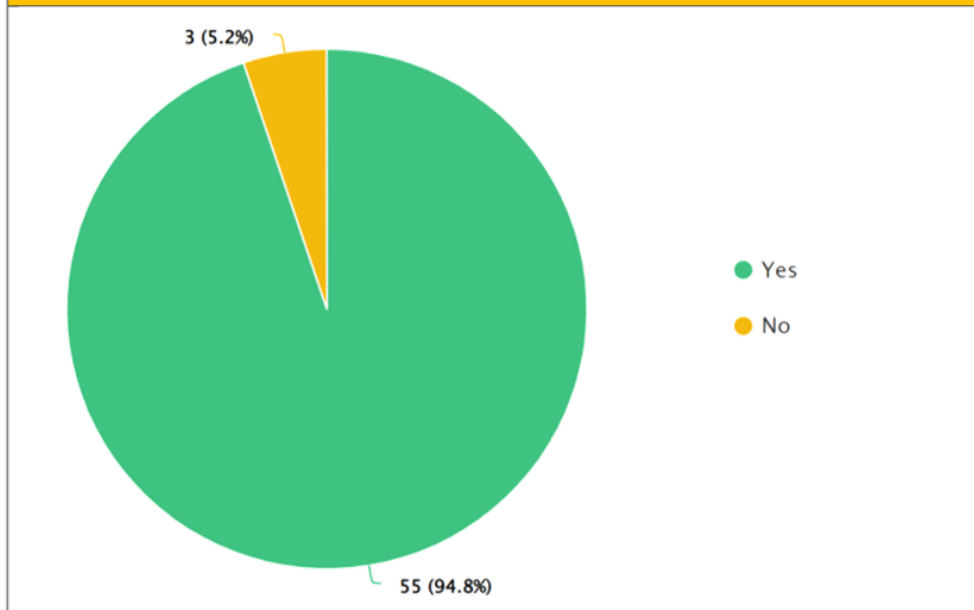

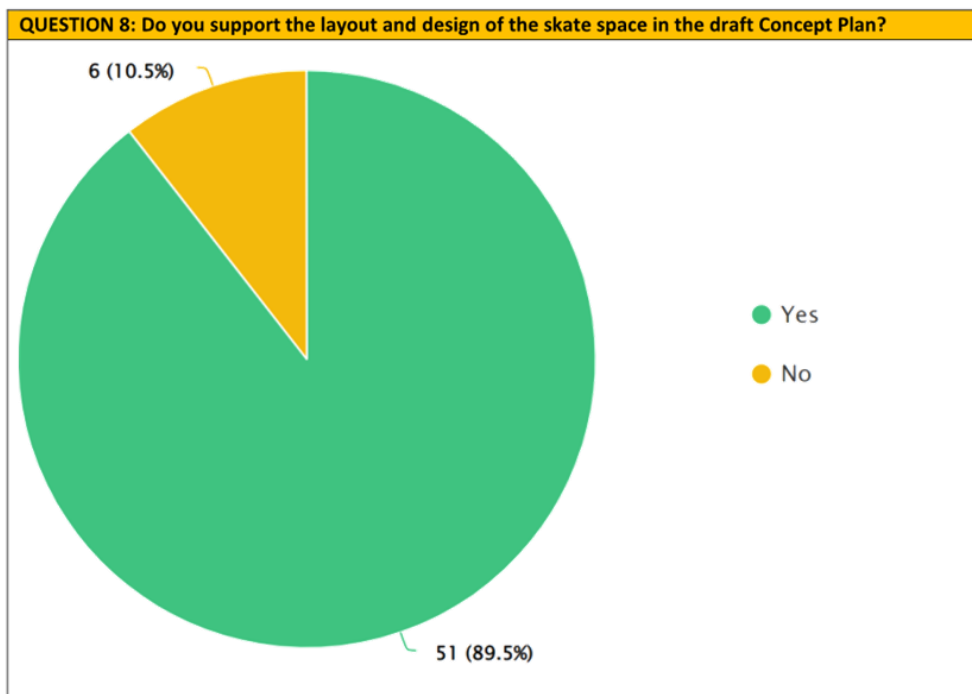

QUESTION 9: Do you have any further comments or suggestions in relation to the draft Concept Plan?

Submitter Comments Verbatim	Administration Comments
It looks a bit negative not supporting the layout. I support the idea and the picnic table and shelter is great for the parents. But I can't see anything for advanced riders at all in the design and even for intermediate riders it seems to be missing jumps and drops. It looks like a lot of quarter pipe and not much else. So I feel the design is missing elements. I'd also love to see some shade cloths over the skate area itself. Without that these sorts of facilities become almost unusable during summer unless it's early morning or late afternoon.	Noted support for picnic table and shelter. This skate space has been designed to cater towards younger children and entry-level skaters, and will enable them to develop their skills and eventually transition to Leederville Skate Park and other more advanced skate parks. The skate space was designed to incorporate the most favoured skateable elements from the preliminary community consultation, and still anticipate usage from a range of varying demographics and abilities.
No	Noted.
The communication received in the post today dated "20 October 2022" does not include any information about elements or layout nor where these can be viewed. As per my comments above, I would suggest a wide variety of urban landscape elements in order to suit the maximum variety of skill levels of youth skates whilst also allowing entry-level-skates a space to develop their skills.	The plans could be viewed via the Imagine Vincent webpage, which the communication directed interested residents to. This skate space has been designed to cater towards younger children and entry-level skaters, and will enable them to develop their skills and eventually transition to Leederville Skate Park and other more advanced skate parks. The skate space was designed to incorporate the most favoured skateable elements from the preliminary community consultation, and still anticipate usage from a range of varying demographics and abilities.
Please make sure lighting and facilities are adequate	Noted.
Please can you consider more than just the transient young population and respect the more senior members of our community. With the lack of policing of this area, it will inevitably attract an older cohort of children / adolescents thereby making it potentially an hostile and non welcoming environment for target cohort of children. I can't tell you how much I don't support this initiative, from what appears to be a council that only supports children and not others.	The skate space is viewed to complement the existing features at the reserve for families and children to interact with. The skate space design includes consideration to the current location and incorporates appropriate landscaping to integrate the provision into the reserve while natural buffering from the active pathway and sporting fields. The reserve is very active and will provide regular passive surveillance to the space, and will retain a clear eyeline from across the majority of the reserve.
Your surveys need a don't know option.	Noted.

the youth area should have a basketball court as it is very popular sport in the area	There are currently two basketball rings at Britannia Reserve, at the north-west section near Litis Stadium and southern end of Britannia Reserve.
Should think of how older and younger can integrate in this area. Add in sun cover, seats, water fountains and lights.	The skate space has incorporated a picnic benches and shaded structure, along with informal seating on logs and the grass embankment. The mature trees to the north and eastern sides will provide additional shade to be comfortable for extended period. No water fountain has been included in the immediate area, however there are 3 water fountains within Britannia Reserve. The skate space itself will not be lit, this is intended due to catering towards younger aged children and not encouraging late night activity in this location.
IMPRESSIVE - KEEP ON DELIVERING THE GOOD NEWS FOR MT HAWTHORN	Noted.
no, I think it will be a great facility for the area	Noted.
Hardy soft landscape is necessary. Will it be lit after dark use? I'm not a skater...for me it's more about encouraging kids to play outdoors and with each other in a safe environment and with pedestrians and dog walkers walking by. A facility for all ages is necessary not just for experienced skaters or teens.	The skate space design has included consideration to the current surrounds and incorporate appropriate landscaping to integrate the provision into the reserve, and will include natural buffering with trees, greenspace and logs to create separation from the active pathway. The skate space itself will not be lit, this is intended due to catering towards younger aged children and not encouraging late night activity in this location.
there may be an issue with dogs wandering onto the skate space and getting in teh way of kids skating etc but I guess that is the responsibility of the dog owners to control	Noted.
Opening access to the space near the skate park to coffee or food vans may be welcomed by parents supervising their kids.	Noted.
Yes I think some kind of lighting is required, some bins too. Loose rubbish would pose a danger to the kids using it. Nice to have something like this in our area.	Bins will be installed at the location. The skate space itself will not be lit, this is intended due to catering towards younger aged children and not encouraging late night activity in this location.
just move it 500 metres next to footy stadium Floreat Athena uses and bring in some toilets is a MUST and think about mixing dogs off leash with kids too	The proposed location was selected by the project Working Group to complement the existing amenities and co-locate with them at the site, attracting the same user demographic that already use the pump track and mountain bike trail. Britannia Reserve does have publicly accessible toilets within the sports club room building, these are managed by the City and are within walking distance to the skate space.
While I think the location is very good, I question how much it will get used.	Noted.
I think the funds should be reallocated.	Noted.
It doesn't seem that there has been thought given to keeping dogs out of the skate park, given that the area is very popular with dog walkers.	Noted.
The space must be safe for all , Security and surveillance and messaging around violence and alcohol or drugs is a must for the well being of many including those who have addictions or suppliers an those who have not been exposed and are not educated , neighbours needs to be safe and be part of a reference group to comment and report on behaviours that are anti social .There may be a need to manage the people who are displaced from being banned from special entertainment zones, that must come into planning or local YP may be at risk for those whose behaviour is not socially responsible and safe and who are itinerate . Youth who are homeless and displaced may also be attracted to a place like this as well, support groups may be able to interact with them at this location . There may be many lessons from the new Bunbury skate park on vandalism and violence and other anti social activity and Vincent may be able to put into place programs to guide and manage risk and unexpected behaviors and migration of youth to an inner city attraction that s been created and to manage the risks of unintended consequences.	The skate space is a small-scale facility that includes supporting infrastructure and greening to be an inviting space for all users. The reserve is very active and will provide regular passive surveillance to the space, and will retain a clear eyeline from across the majority of the reserve. The skate space itself will not be lit, this is intended due to catering towards younger aged children and not encouraging late night activity in this location.
Just put the skate park closer to the car park so youth can access it without competing with the pedestrians & wheel chair users for the pathway. When the pump track was newer, parents & children were very insensitive to the needs of pedestrians in accessing it and would take up the path without regard for those with hearing/visual impairment or mobility issues. It was distressing for established users. If the skate space has to be there, please put in a pedestrian & a cycle/skate path for access so both sets of users can enjoy the Britannia reserve safely.	The active footpath is not in the project scope, however note this comment for reserve considerations and will be monitored following the construction of the skate space. If regular conflicts emerge following its implementation then will look at measures to alleviate this.
Not being a skater its difficult to comment on the layout and design of the skate space. The is best left to those who will use it. As I am 67 yrs old my skate board days are limited to my driveway.	Noted.
Area for parents to sit and be able to see the children. The longer a person can stay & sit, the longer the kids will play. BBQ nearby to create hub in the future.	Noted. There are two BBQ's currently at Britannia Reserve, on the north and southern ends of the reserve.
No skateboards on footpath. Speed limits displayed for footpath. Too many fast cyclists + e scooters.	The active footpath is not in the project scope, however note this comment for reserve considerations and will be monitored following the construction of the skate space. If regular conflicts emerge following its implementation then will look at measures to alleviate this.

Email Submissions

Written Submission #1

I live and work within the local community and am also a parent who frequents Britannia Reserve.

This skate park is an excellent idea!

I can imagine it would lend itself to small festivals with food trucks etc or even a monthly community meet up?

Much like Axford Park which was wonderful...

My vote is a BIG YES!

Summarised Submitter Comments	Administration Comments
Support for the skate space.	Noted.

Written Submission #2

I received your postage today about your survey. The survey would not load and then stated it had concluded. Maybe you have pulled it prematurely?

I'll give my opinion anyway:

Brittania Park is probably under-appreciated as a natural gem. I regularly use the bush, bike and pedestrian trails that the gardening team keep looking so natural and well kept.

This should be the focus of any enhancement not some concrete skate park that would detract and should be placed in a built up area like the existing one on Oxford St.

If you would like some ideas to enhance Britannia?

- 1. Please remove the bicycle obstructions on the existing sealed pathways. It is legal for cyclist to use these paths.*
- 2. Have a small fenced area for dogs to exercise as dogs are your main customers.*
- 3. Develop the messy area west of the cricket nets and food services?*
- 4. Make the trail bike track safer and more dual purpose for bikes and people walking dogs as well as youngsters. It could be wider with more signage about its one way nature and hazards from speeding bikes and dogs should be kept on leads.*
- 5. Survey the use of the extreme jumps and pine log obstruction on the trail and remove them if thought fit or at least make them alternative routes. By survey I mean see if they are actually used with a fixed camera or observer.*
- 6. Plant more trees and natural vegetation and perhaps change some grass to gardens. The flat expansive grass areas could be seen as boring.*

Regards: XXXX

Lives 500m from Britannia.

Did not participate in previous survey.

Have little idea of your concept plan as is no illustration in the correspondence and I'm not sure what the pump track is. But I oppose such use of our lovely land especially if forested.

Summarised Submitter Comments	Administration Comments
Current use of Britannia Reserve.	Noted.
Opposition of skate space	Noted. The skate space design has included considerations to the current surrounds and will incorporate appropriate landscaping to integrate the provision into the reserve.
Ideas to enhance Britannia Reserve	These will be noted for consideration with current and future planning of Britannia Reserve.